

DESCRIPTION OF SURVEY FOR
SAMUEL DUNN, PATRICK DUNN, & MICHAEL DUNN JOB#2271-2

Situated in the State of Ohio, County of Muskingum, Township of Newton:

Being part of the Southwest Quarter, Section 33, Township 15, Range 14, of the of the Congress Lands East of the Scioto River further **being part of** the Samuel Dunn, Patrick Dunn and Michael Dunn property recorded in **Official Record Volume 1578, Page 823** of said county's deed records, further **being part of** Muskingum County Auditor's Parcel Number **47-86-33-17-000**, and more particularly described as follows;

- Commencing at a stone (found) at the Center of said Section 33;
- TIE- THENCE North 86 degrees 59 minutes 23 seconds West 1234.77 feet** along the common line for the Northwest and Southwest Quarters of Section 33 to an iron pin (set) at the place of beginning for the property herein intended to be described;
- #1- THENCE South 14 degrees 20 minutes 28 seconds East 573.27 feet** into said Southwest Quarter and said Dunn property to an iron pin (set);
- #2- THENCE North 76 degrees 06 minutes 21 seconds East 527.62 feet** continuing through said Dunn property to an iron pin (set);
- #3- THENCE South 17 degrees 00 minutes 15 seconds East 761.81 feet** continuing through said Dunn property to an iron pin (set);
- #4- THENCE South 41 degrees 55 minutes 46 seconds West 266.37 feet** continuing through said Dunn property to an iron pin (set) on a line of the Michael Dunn property recorded in Official Record Volume 1603, Page 898;
- #5- THENCE North 14 degrees 07 minutes 22 seconds West 362.58 feet** along said S,P, & M Dunn and Michael Dunn properties to an iron pin (found);
- #6- THENCE South 73 degrees 19 minutes 51 seconds West 225.19 feet** continuing along said properties to an iron pin (found);
- #7- THENCE South 21 degrees 37 minutes 54 seconds East 491.76 feet** continuing along said properties to an unmarked point in the centerline of Fultonrose Road, passing an iron pin (found) at 466.76 feet;
- #8- THENCE North 87 degrees 10 minutes 30 seconds West 400.17 feet** along said road and common line for said Dunn property and for the Jerry E Dunn and Lori A Dunn property recorded in Official Record Volume 2089, Page 76 and for the Opal V Dunn Trustee property recorded in Official Record Volume 2379, Page 79 to the unmarked Southeast corner of the Richard H McDonald property recorded in Official Record Volume 2142, Page 892;
- #9- THENCE North 04 degrees 17 minutes 54 seconds East 441.37 feet** leaving said road and along a common line for said S, R, & M Dunn and McDonald properties to a pipe (found), passing an iron pin (found) at 17.00 feet;
- #10- THENCE South 89 degrees 53 minutes 54 seconds West 240.65 feet** continuing along said properties to an iron pin (set) on a line of said Opal V Dunn Trustee property;
- #11- THENCE North 04 degrees 17 minutes 16 seconds East 97.10 feet** along said S, P, & M Dunn and Opal V. Dunn properties to an iron pin (set);
- #12- THENCE North 86 degrees 37 minutes 31 seconds West 417.14 feet** continuing along said properties to a mine bolt (found) at a corner of Alan M Buco and Joyce M Buco property recorded in Official Record Volume 2311, Page 223;
- #13- THENCE North 03 degrees 06 minutes 13 seconds East 966.50 feet** along the common line for said S, P, & M Dunn and Buco properties to a stone (found) on the common line for the Southwest and Northwest Quarters of Section 33;
- #14- THENCE South 86 degrees 59 minutes 23 seconds East 388.56 feet** along said Quarter Section line and common line S, P, & M Dunn property and for the AEP GENERATION RESOURCES INC. property recorded in Official Record Volume 2519, Page 194 to the place of beginning, **containing 23.85 acres**, of which 0.18 acres are within the right of way for Fultonrose Road.

The bearings within this description are based on State Plane Coordinate Grid (Ohio South 1983) derived from GPS Observations. Iron pins (set) are 5/8" rebar with identification caps (C.R.Harkness P.L.S.6885).

This description was written by Charles R. Harkness Professional Land Surveyor #6885 from an actual survey completed on October 2, 2015 in accordance with Chapter 4733-37 of the Administrative Code, and is intended to be used for the legal transfer of the property described and does not intend to describe any apparent easements nor easements of record, unless otherwise indicated.

OFFICE COPY
NOT RECORDED
Charles R. Harkness PLS #6885

DESCRIPTION
APPROVED
By: *[Signature]* 10/15/2015



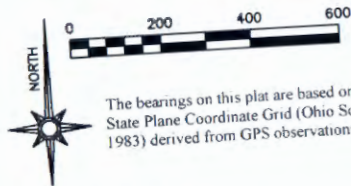

LEGEND

- PIN (SET) 5/8" REBAR CAPPED (C R HARKNESS PLS #6885)
- PIN (FOUND)
- △ POINT (UNMARKED)
- PIPE (FOUND)
- STONE (FOUND) WITH X
- MAG NAIL (FOUND)
- MINE ROOF BOLT (FOUND)

Situated in the State of Ohio, County of Muskingum, Township of Newton:

PARCEL ONE

Being part of the Southwest Quarter, Section 33, Township 15, Range 14, of the Congress Lands East of the Scioto River, being part of the Samuel Dunn, Patrick Dunn, and Michael Dunn property recorded in Official Record Volume 1578, Page 823 of said county's deed records, further being part of Muskingum County Auditor's Parcel Number 47-86-33-17-000:

PARCEL TWO

Being part of the Southwest Quarter, Section 33, Township 15, Range 14, of the Congress Lands East of the Scioto River, being part of the Samuel Dunn, Patrick Dunn, and Michael Dunn property recorded in Official Record Volume 1578, Page 823 of said county's deed records, further being part of Muskingum County Auditor's Parcel Number 47-86-33-17-000:

SURVEYOR'S NOTES AND REFERENCES:

Muskingum County Tax Maps and Orthophotos of the area. All other references are shown or listed.

Note #1- Parcel One and Two include all of the remaining property recorded in the Samuel Dunn, Patrick Dunn, and Michael Dunn property recorded in Official Record Volume 1578, Page 823 of said county's deed records, further being all of Muskingum County Auditor's Parcel Number 47-86-33-17-000.

DESCRIPTION

APPROVED

By: *[Signature]* 10/15/2015

This plat was prepared by C.R. Harkness Surveying & Mapping Inc. in accordance with Chapter 4733-37 of the Administrative Code, and is intended to be used for the legal transfer of the parcel surveyed and does not show any appurtenant easements or encumbrances of record, unless otherwise indicated.



SURVEY FOR:
Samuel, Patrick, &
Michael Dunn



HARKNESS SURVEYING & MAPPING, INC.
8205 OLD TOWN ROAD
ROSEVILLE, OHIO 43777
PHONE/FAX (740) 849-0122



JOB NUMBER
Job#2271

DRAWING / SHEET #
Plat #01

SURVEYED: 10/02/15 DRAWN: 10/02/15

Nelson McCoy Melick &
Marlene Freda Melick
Trustees
OR Vol. 2190, Page 643.

AEP GENERATION RESOURCES INC
OR Vol. 2519, Page 194.

AEP GENERATION RESOURCES INC
OR Vol. 2519, Page 194.

Alan M Buco & Joyce M Buco
OR Vol. 2311, Page 223.

Parcel Two
23.85 Acres

Samuel Dunn,
Patrick Dunn, &
Michael Dunn
OR Vol. 1578,
Page 823.
Part Parcel Number
47-86-33-17-000

Opal V Dunn
Trustee
OR Vol. 2379,
Page 79.

Opal V Dunn
Trustee
OR Vol. 2379,
Page 79.

Richard H McDonald
OR Vol. 2142,
Page 892.

Opal V Dunn Trustee
OR Vol. 2379, Page 79.

Jerry E Dunn & Lori A Dunn
OR Vol. 2089, Page 76.

Opal V Dunn Trustee
OR Vol. 2379, Page 79.

SW Qtr Section 33
SE Qtr Section 33

Harold O Paxton
DB Vol. 989, Page 321.

Nelson McCoy Melick &
Marlene Freda Melick
Trustees
OR Vol. 2190, Page 643.

NE Qtr
Sec 33

SE Qtr
Sec 33

Commencing-2

NW Qtr
Sec 33

SW Qtr Sec 33

Parcel One
22.16 Acres

Samuel Dunn,
Patrick Dunn, &
Michael Dunn
OR Vol. 1578,
Page 823.
Part Parcel Number
47-86-33-17-000