

Situated in the State of Ohio, County of Muskingum, Township of Newton:

Being part of Section 34, Township 15, Range 14, of the Congress Lands East of the Scioto River, further **being part of** the Victoria I May property recorded in **Official Record Volume 2454, Page 944** of said county's deed records, further **being part of** Muskingum County **Auditor's Parcel Number 47-94-34-33-000** and more particularly described as follows;

Commencing at an iron pin (found) at the common Southern corner of Lots #93 and 94 of the First Addition to Beem City recorded in Plat Book 4, Page 35, further being on the North line of 3rd Street of said Addition;

- TIE- THENCE North 86 degrees 57 minutes 32 seconds West 144.15 feet** along the North line of 3rd Street and South lines of Lots 94 and 95 of said Addition, and crossing a 10 foot wide alley and 6 foot wide reserved strip to a cotton gin spike (set) at the Southeast corner of the Pentecostal Church of God, Ohio District property recorded in Official Record Volume 2269, Page 292, further being the place of beginning for the property herein intended to be described, passing a railroad spike (found) at 125.23 feet;
- #1- THENCE South 37 degrees 36 minutes 13 seconds West 316.70 feet** along the Western line of said 6 foot wide strip and Addition, also a line of said May property to an unmarked corner for said Addition and May property, passing an iron pin (set) at 302.94 feet;
- #2- THENCE South 76 degrees 53 minutes 03 seconds West 110.42 feet** through said May property to an iron pin (set);
- #3- THENCE South 89 degrees 36 minutes 33 seconds West 243.89 feet** continuing through said property to an iron pin (set);
- #4- THENCE North 17 degrees 07 minutes 30 seconds West 109.76 feet** continuing through said property to an iron pin (set);
- #5- THENCE North 06 degrees 06 minutes 26 seconds East 170.76 feet** continuing through said property to an iron pin (set);
- #6- THENCE North 35 degrees 54 minutes 50 seconds East 96.56 feet** continuing through said property to an iron pin (set);
- #7- THENCE South 57 degrees 29 minutes 42 seconds East 411.40 feet** continuing through said property to an iron pin (set);
- #8- THENCE North 37 degrees 36 minutes 13 seconds East 186.82 feet** continuing through said property to a cotton gin spike (set) on the South line of said Pentecostal Church property;
- #9- THENCE South 86 degrees 57 minutes 32 seconds East 41.29** along said Pentecostal Church property to the place of beginning, **containing 2.47 acres.**

The bearings within this description are based on State Plane Coordinate Grid (Ohio South 1983) derived from GPS Observations. Iron pins (set) are 5/8" rebar with identification caps (C.R.Harkness P.L.S.6885).

This description was written by Charles R. Harkness Professional Land Surveyor #6885 from an actual survey completed on May 2, 2016 in accordance with Chapter 4733-37 of the Administrative Code, and is intended to be used for the legal transfer of the property described and does not intend to describe any apparent easements nor easements of record, unless otherwise indicated.

OFFICE COPY

Charles R. Harkness PLS #6885

APPROVED
MUSKINGUM COUNTY
PLANNING COMMISSION DIRECTOR

Date

Fee Paid



DESCRIPTION
APPROVED

By: *[Signature]* 5/12/16

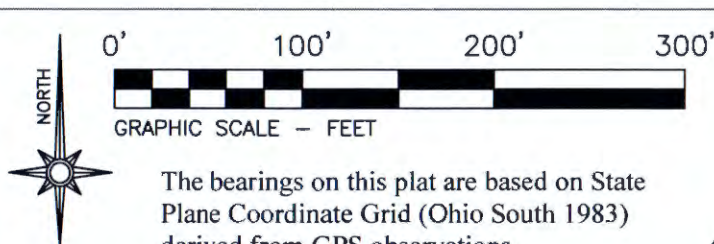

Situated in the State of Ohio, County of Muskingum, Township of Newton:

Being part of Section 34, Township 15, Range 14, of the Congress Lands East of the Scioto River, further **being part of** the Victoria I May property recorded in **Official Record Volume 2454, Page 944** of said county's deed records, further **being part of** Muskingum County **Auditor's Parcel Number 47-94-34-33-000**:

SURVEYOR'S NOTES AND REFERENCES:

Muskingum County Tax Maps and Orthophotos of the area.

All other references are shown or listed.

Note #1- Existing House crossing alley and property line.

Approved for Transfer
No On-Lot Sewage
Zanesville-Muskingum Co.
Health Department

LEGEND

- PIN (SET) 5/8" REBAR CAPPED
(C R HARKNESS PLS #6885)
- PIN (FOUND)
- △ POINT (UNMARKED)
- ☼ COTTON GIN SPIKE (SET)
- ◎ RAILROAD SPIKE (FOUND)



APPROVED
MUSKINGUM COUNTY
PLANNING COMMISSION DIRECTOR

2.47 Acres

Victoria | May
OR Vol. 2454, Page 944.
Part of Parcel Number
47-94-34-33-000

This plat was prepared by C.R. Harkness Surveying & Mapping Inc. in accordance with Chapter 4733-37 of the Administrative Code, and is intended to be used for the legal transfer of the parcel surveyed and does not show any apparent easements nor easements of record, unless otherwise indicated.

OFFICE COPY
Charles R. Harkness
Charles R. Harkness PLS #6885
NOT RECORDED

DESCRIPTION

APPROVED
By: [Signature] 6/22/16

Victoria I May
OR Vol. 2454, Page 944.
Part of Parcel Number
47-94-34-33-000

S 02°59'52" W 858.16'
To Pin Re-Set

SURVEY FOR:

**Jerry May &
Victoria I May**



HARKNESS SURVEYING & MAPPING, INC.

8205 OLD TOWN ROAD
ROSEVILLE, OHIO 43777
PHONE/FAX (740) 849-0122



SURVEYED: 5/2/2016 DRAWN: 5/3/2016

JOB NUMBER
Job#2321

DRAWING / SHEET #
Plat #01