

SURVEY FOR CHAD KETTLEWELL

AUDITORS PARCEL NUMBER

51-80-22-25-003 (PART)

TO BE COMBINED WITH 51-80-22-25-001

BEING A PART OF THE PARCEL CONVEYED TO KEITH A. AND ALISHA J. SHOOK IN O.R. VOLUME 2431, PAGE 467 OF THE MUSKINGUM COUNTY OFFICIAL RECORDS. SITUATED IN THE SOUTHEAST QUARTER OF SECTION 22, TOWNSHIP 1, RANGE 6, OF THE UNITED STATES MILITARY LANDS, PERRY TOWNSHIP, MUSKINGUM COUNTY, OHIO.

BEARINGS ARE BASED ON OHIO STATE PLANE COORDINATE SYSTEM 1983(2011), OHIO SOUTH ZONE, GRID, DERIVED FROM A GPS OBSERVATION.

APPROVED
MUSKINGUM COUNTY
PLANNING COMMISSION DIRECTOR

5/8" REBAR
WITH "TCW" CAP

NORTHEAST CORNER OF
THE SOUTHEAST QUARTER
OF SECTION 22

Date

Fee Paid

51-80-22-25-001
WILLIAM N. & TERESA J. KETTLEWELL
DEED VOL. 982, PG. 158

NOTE 1: ALL EXISTING STRUCTURES ARE
ON THE PARCEL TO BE RETAINED.
NOTE 2: 4" STEEL PIPES FILLED WITH
CONCRETE APPEAR TO HAVE BEEN SET
ON TOP OF PREVIOUSLY CALLED FOR
IRON PINS.

TO BE RELEASED

51-80-22-25-003 (PART)
KEITH A. & ALISHA J. SHOOK
O.R. VOL. 2431, PG. 467
1.056 ACRES

TO BE RETAINED
51-80-22-25-003
KEITH A. & ALISHA J. SHOOK
O.R. VOL. 2431, PG. 467
4.744 ACRES REMAINING (BY DEED)

SUSAN J. DECKER
DEED VOL. 1054, PG. 373

LARRY E. & JILL A. MERRY
DEED VOL. 1159, PG. 538

RESEARCH

DEEDS AS SHOWN

PREVIOUS SURVEY OF A 3.15 AC. PARCEL
COMPLETED MARCH 19, 2021 BY L.P. DINAN PS5451
PREVIOUS SURVEY OF A 74.533 AC. PARCEL
COMPLETED APRIL 20, 2001 BY K.L. WORTHINGTON PS7054
PREVIOUS SURVEY OF A 5.141 AC. PARCEL
COMPLETED MARCH 6, 1995 BY T.J. FINLEY PS7222
PREVIOUS SURVEY OF A 19.22 AC. PARCEL
COMPLETED JULY 3, 2003 BY C.R. HARKNESS PS6885
PREVIOUS SURVEY OF A 5.013 AC. PARCEL
COMPLETED OCT. 8, 1990 BY C.R. HARKNESS PS6885
PREVIOUS SURVEY OF A 20.61 AC. PARCEL
COMPLETED JULY 23, 1985 BY L.P. DINAN PS5451
PREVIOUS SURVEY OF A 5.80 AC. PARCEL
COMPLETED AUG. 7, 2009 BY L.P. DINAN PS5451
PREVIOUS SURVEY OF A 7.62± AC. PARCEL
COMPLETED AUG. 4, 2012 BY B.K. McPEEK PS8517
PREVIOUS SURVEY OF A 73.766± AC. PARCEL
COMPLETED NOV. 7, 2014 BY B.K. McPEEK PS8517
PREVIOUS SURVEY OF A 10.96 AC. PARCEL
COMPLETED JAN. 16, 1987 BY L.P. DINAN PS5451
MUSKINGUM COUNTY GIS

DESCRIPTION APPROVED

By: *Jason Leachman*

LEGEND

- EXISTING IRON PIN
- ⊙ IRON PIN SET
(5/8" REBAR W/CAP)
- ANGLE POINTS
- ▲ RAILROAD SPIKE FOUND

NOT TO BE USED AS A SEPARATE BUILDING
SITE OR TRANSFERRED AS AN INDEPENDENT
PARCEL IN THE FUTURE WITHOUT PLANNING
COMMISSION APPROVAL IN ACCORDANCE WITH
APPLICABLE SUBDIVISION REGULATIONS.

SCALE 1"=200'

0 100 200 400

I, JASON LEACHMAN, HEREBY CERTIFY TO
THE BEST OF MY KNOWLEDGE AND BELIEF THE
ABOVE PLAT AND SURVEY TO BE CORRECT AS
PREPARED BY ME ON THIS 22ND DAY OF FEBRUARY,
2022. FOR THE PURPOSE OF THIS SURVEY, I COMPLETED THE
21ST DAY OF FEBRUARY, 2022.

NOT RECORDABLE
JASON LEACHMAN
PROFESSIONAL SURVEYOR #8536

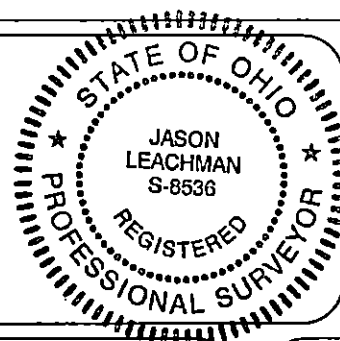

THIS PROPERTY IS SUBJECT TO ALL APPLICABLE
EASEMENTS, RIGHT OF WAYS, OR RESTRICTIONS,
WHETHER RECORDED OR IMPLIED. THIS PLAT,
PREPARED IN ACCORDANCE WITH CHAPTER
4733-37 OF THE ADMINISTRATIVE CODE, IS
INTENDED FOR THE LEGAL TRANSFER OF THE
PROPERTY SHOWN AND DOES NOT INTEND TO
SHOW ANY OR ALL OF THE EASEMENTS, RIGHT
OF WAYS, RESTRICTIONS OR ENCROACHMENTS
UNLESS OTHERWISE INDICATED.

BASELINE SURVEYING, INC.

3010 EAST PIKE, ZANESVILLE, OHIO 43701

phone: 740-453-4850, email: BEI@rohlo.com, www.BaselineSurveyinginc.com

DRAWN BY: JWJ

DATE: 02-22-22

SCALE: 1"=200'

CHECKED BY: MDN

JOB NO: 6503

DRAWING NO:

Z:\6503\6503.dwg