

# Baseline Surveying, Inc.

Land Surveying and Construction Layout

3010 East Pike  
Zanesville, OH 43701

Email: bei@rohio.com  
Telephone (740) 453-4850

**THENCE WITH THE NORTH AND WEST LINE OF THE SAID BASEHART PARCELS THE FOLLOWING THREE COURSES AND DISTANCES:**

1. NORTH 87 DEGREES 12 MINUTES 56 SECONDS WEST 198.28 FEET TO AN EXISTING IRON PIN (5/8 INCH REBAR WITH "HARKNESS" CAP IN CONCRETE);
2. NORTH 85 DEGREES 10 MINUTES 59 SECONDS WEST 125.30 FEET TO AN EXISTING IRON PIN (5/8 INCH REBAR WITH "HARKNESS" CAP);
3. SOUTH 16 DEGREES 06 MINUTES 46 SECONDS WEST 190.89 FEET TO AN IRON PIN SET;

**THENCE LEAVING THE WEST LINE OF THE SAID BASEHART PARCELS AND TRAVERSING THROUGH THE ABOVE SAID WISECARVER, WISECARVER, BASEHART AND LEHOTAY PARCEL, NORTH 87 DEGREES 25 MINUTES 50 SECONDS WEST 664.19 FEET TO THE PLACE OF BEGINNING;**

**CONTAINING 6.500 ACRES, SUBJECT TO ALL APPLICABLE EASEMENTS.**

**NOT TO BE USED AS A SEPARATE BUILDING SITE OR TRANSFERRED AS AN INDEPENDENT PARCEL IN THE FUTURE WITHOUT PLANNING COMMISSION APPROVAL IN ACCORDANCE WITH APPLICABLE SUBDIVISION REGULATIONS.**

**ALL IRON PINS SET ARE 5/8 INCH X 30 INCH REBAR WITH PLASTIC IDENTIFICATION CAPS (BASELINE PS6923-PS8536).**

**BEARINGS ARE BASED ON OHIO STATE PLANE COORDINATE SYSTEM 1983 (2011), OHIO SOUTH ZONE, GRID, DERIVED FROM A GPS OBSERVATION**

**I, MICHAEL D. NICHOLS, PS 6923, HEREBY CERTIFY TO THE BEST OF MY KNOWLEDGE AND BELIEF THE SURVEY AND DESCRIPTION TO BE CORRECT AS PREPARED BY ME, THIS 21ST DAY OF DECEMBER 2021, FROM A FIELD SURVEY COMPLETED ON THE 21ST DAY OF DECEMBER 2021.**

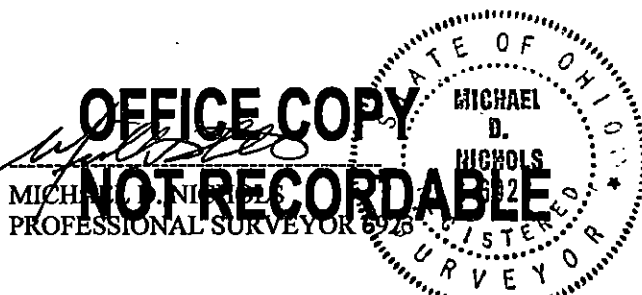

DESCRIPTION  
APPROVED

By: 12/29/2021

