

Baseline Surveying, Inc.

Land Surveying and Construction Layout

3010 East Pike
Zanesville, OH 43701

Email: bei@rroho.com
Telephone (740) 453-4850

CONTAINING 5.000 ACRES, SUBJECT TO ALL LEGAL ROAD RIGHT OF WAYS OF SALEM CHURCH ROAD (COUNTY ROAD 18) AND ALL OTHER APPLICABLE EASEMENTS.

ALL IRON PINS SET ARE 5/8 INCH X 30 INCH REBAR WITH PLASTIC IDENTIFICATION CAPS (BASELINE PS6923-PS8536).

BEARINGS ARE BASED ON OHIO STATE PLANE COORDINATE SYSTEM 1983 (2011), OHIO SOUTH ZONE, GRID, DERIVED FROM A GPS OBSERVATION.

I, JASON LEACHMAN, PS 8536, HEREBY CERTIFY TO THE BEST OF MY KNOWLEDGE AND BELIEF THE SURVEY AND DESCRIPTION TO BE CORRECT AS PREPARED BY ME, THIS 17TH DAY OF MAY 2021, FROM A FIELD SURVEY COMPLETED BY ME ON THE 14TH DAY OF MAY 2021.

**OFFICE COPY
NOT RECORDABLE**

JASON LEACHMAN
PROFESSIONAL SURVEYOR 8536

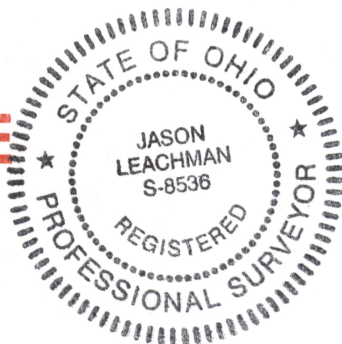

DESCRIPTION

APPROVED

By: Jason Leachman

**APPROVED
MUSKINGUM COUNTY
PLANNING COMMISSION DIRECTOR**

6/2/21
Date

Fee Paid