



Elizabeth A. Darner
OR 3074-330
All of: 56-50-08-14-000
+/-10.432 Acres

Situated in the State of Ohio, County of Muskingum, Township of Salem, being part of the North Half of the Southwest Quarter of Section 8, Township 2, Range 6 and being all of the lands now owned by Elizabeth A. Darner as recorded in OR 3074-330 of the Muskingum County Recorders Office and more particularly described as follows.

Beginning for reference at a stone found at the southeast corner of the north half of the southwest quarter of said Section 8, thence N 60°57'04" W a distance of 717.87 feet to a point in the center of Knicely Road (TR-356), the principal place of beginning;

thence with the center of said Knicely Road the following six (6) courses:

1. N 56°46'30" W a distance of 81.45 feet to a point;
2. N 59°20'16" W a distance of 78.41 feet to a point;
3. N 61°24'27" W a distance of 567.65 feet to a point;
4. with a curve to the right having an radius of 85.19 feet, an arc length of 74.79 feet and and chord bearing N 36°15'20" W a distance of 72.41 feet to a point;
5. N 10°59'36" W a distance of 125.70 feet to a point;
6. N 14°08'24" W a distance of 495.57 feet to a point at the southwest corner of the lands now owned by Ruth C. Knicely & Richard Knicely, Trust (OR 1769-61);

thence with the common line of said Darner/Knicely, Trust's lands, S 87°58'35" E a distance of 250.57 feet to a point, said point being the northwest corner of the lands now owned by Rodney A. Paisley (OR 2308-756), passing an iron pin set at 18.11 feet and an iron pin found (5/8") at 247.15 feet;

thence with the common line of said Darner/Paisley's land's the following seven (7) courses:

1. S 57°42'06" E a distance of 265.65 feet to a point, referenced by an iron pin found (dinan) that bears N 88°44'19" W a distance of 3.47 feet;
2. S 02°11'30" W a distance of 103.53 feet to an iron pin found (dinan);
3. S 17°43'56" W a distance of 158.21 feet to an iron pin found (5/8");
4. S 78°04'40" E a distance of 411.18 feet to an iron pin found (5/8");
5. S 24°11'23" E a distance of 239.19 feet to an iron pin found (dinan);
6. S 06°16'39" E a distance of 124.82 feet to an iron pin found (dinan);
7. S 31°38'44" W a distance of 219.05 feet to the place of beginning, passing an iron pin found (dinan) at 195.13 feet, containing a total of 10.432 acres more or less, subject to all legal highways and easements of record.

All bearings described herein are based on the Ohio State Plane Grid Coordinates, NAD83, Ohio South, Grid North per GPS Observation.

All iron pins set are 5/8 inch by 30 inch steel rebar with plastic identification caps marked MCPEEK PS8517.

The above described 10.432 acre parcel is based on a field survey made by Brian K. McPeek of McPeek Land Surveying on December 18th, 2024.

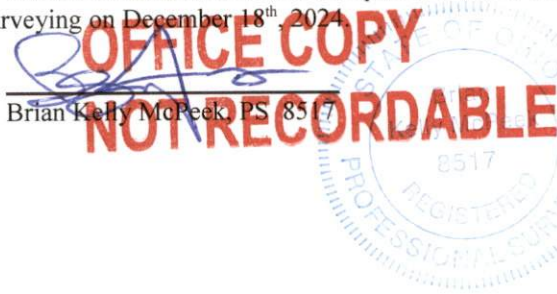

12/18/24
Date

DESCRIPTION
APPROVED
By: AK 11/7/25