

Sl-90-21-15-010 A

## Baseline Surveying, Inc.

Land Surveying and Construction Layout

3010 East Pike  
Zanesville, OH 43701

Email: bei@rrohio.com  
Telephone (740) 453-4850

CONTAINING 0.130 ACRES, SUBJECT TO A 15 FEET WIDE INGRESS/EGRESS EASEMENT AS RECORDED IN O.R. VOLUME 2140, PAGE 216, AND ALL OTHER APPLICABLE EASEMENTS.

NOT TO BE USED AS A SEPARATE BUILDING SITE OR TRANSFERRED AS AN INDEPENDENT PARCEL IN THE FUTURE WITHOUT PLANNING COMMISSION APPROVAL IN ACCORDANCE WITH APPLICABLE SUBDIVISION REGULATIONS.

ALL IRON PINS SET ARE 5/8 INCH X 30 INCH REBAR WITH PLASTIC IDENTIFICATION CAPS (BASELINE PS6923-PS8536).

BEARINGS ARE BASED ON OHIO STATE PLANE COORDINATE SYSTEM 1983 (2011), OHIO SOUTH ZONE, GRID, DERIVED FROM A GPS OBSERVATION.

I, JASON LEACHMAN, PS 8536, HEREBY CERTIFY TO THE BEST OF MY KNOWLEDGE AND BELIEF THE SURVEY AND DESCRIPTION TO BE CORRECT AS PREPARED BY ME, THIS 13TH DAY OF OCTOBER 2020, FROM A FIELD SURVEY COMPLETED BY ME ON THE 13TH DAY OF OCTOBER 2020.

OFFICE COPY

NOT RECORDABLE

JASON LEACHMAN  
PROFESSIONAL SURVEYOR 8536

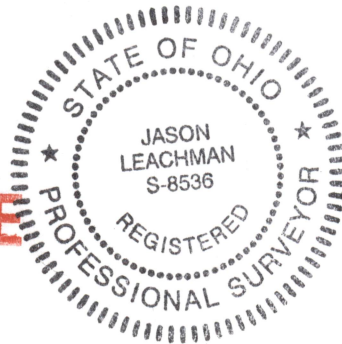

DESCRIPTION

APPROVED

By: Deborah

APPROVED  
MUSKINGUM COUNTY  
PLANNING COMMISSION DIRECTOR

Date

Fee Paid