

Baseline Surveying, Inc.

Land Surveying and Construction Layout

3010 East Pike
Zanesville, OH 43701

Email: bei@rrohio.com
Telephone (740) 453-4850

5. NORTH 61 DEGREES 22 MINUTES 36 SECONDS EAST 111.84 FEET TO A POINT;
6. NORTH 64 DEGREES 58 MINUTES 27 SECONDS EAST 60.57 FEET TO A POINT;
7. NORTH 67 DEGREES 49 MINUTES 51 SECONDS EAST 31.75 FEET TO A POINT, SAID POINT BEING SOUTH 15 DEGREES 56 MINUTES 17 SECONDS EAST 19.90 FEET FROM AN EXISTING IRON PIN (5/8 INCH REBAR WITH BASELINE CAP);

THENCE CONTINUING WITH THE CENTER OF TUMBLIN ROAD AND TRAVERSING INTO THE ABOVE SAID SCHLABACH FIRST PARCEL, WITH THE SOUTH LINE OF A PREVIOUSLY COMPLETED 7.357 ACRE SURVEY THE FOLLOWING THREE COURSES AND DISTANCES:

1. NORTH 67 DEGREES 49 MINUTES 56 SECONDS EAST 27.72 FEET TO A POINT;
2. NORTH 73 DEGREES 03 MINUTES 58 SECONDS EAST 132.23 FEET TO A POINT;
3. NORTH 76 DEGREES 54 MINUTES 25 SECONDS EAST 116.74 FEET TO A POINT;

THENCE LEAVING THE SAID ROAD AND CONTINUING THROUGH THE SAID SCHLABACH FIRST PARCEL, SOUTH 02 DEGREES 45 MINUTES 35 SECONDS WEST, PASSING AN IRON PIN SET AT 30.00 FEET AND AT 563.18 FEET, A TOTAL DISTANCE OF 2211.05 FEET TO THE **PLACE OF BEGINNING**.

CONTAINING 40.909 ACRES FROM AUDITOR'S PARCEL NUMBER 60-30-11-06-000. SUBJECT TO ALL LEGAL ROAD RIGHT OF WAYS OF OKEY ROAD (TOWNSHIP ROAD 209) AND TUMBLIN ROAD (TOWNSHIP ROAD 390) AND ALL OTHER APPLICABLE EASEMENTS.

ALL IRON PINS SET ARE 30 INCH LONG 5/8 INCH DIAMETER REBAR WITH PLASTIC IDENTIFICATION CAP MARKED BASELINE PS6923-PS8536.

BEARINGS ARE BASED ON OHIO STATE PLANE COORDINATE SYSTEM 1983 (2011), OHIO SOUTH ZONE, GRID, DERIVED FROM A GPS OBSERVATION.

I, JASON LEACHMAN, PS 8536, HEREBY CERTIFY TO THE BEST OF MY KNOWLEDGE AND BELIEF THE SURVEY AND DESCRIPTION TO BE CORRECT AS PREPARED BY ME, THIS 27TH DAY OF FEBRUARY 2024, FROM A FIELD SURVEY COMPLETED BY ME ON THE 26TH DAY OF FEBRUARY 2024.

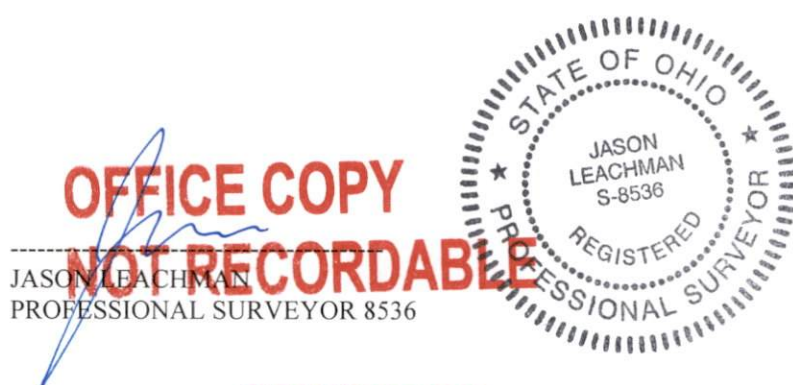

DESCRIPTION

APPROVED

By: Jason Leachman 2/27/24