

22. S 07°58'11" E a distance of 25.62 feet to a point;
23. S 10°07'29" E a distance of 14.43 feet to a point;
24. S 00°00'00" E a distance of 10.00 feet to a point on the north line of the lands now owned by Wava E. Shuster (OR 1077-80);

Thence leaving the center of said Buffalo Fork and going with the common line of said Eck/Shuster's lands the following two (2) courses:

1. N 90°00'00" W a distance of 215.60 feet to an iron pin set, passing an iron pin set at 35.91 feet;
2. S 05°31'26" W a distance of 122.88 feet to an iron pin set at the northeast corner of the lands now owned by Gage & Gavel Masonic Lodge 448 (DR 499-714);

Thence with the north line of said Gage & Gavel Masonic Lodge 448's lands, N 69°39'14" W a distance of 224.95 feet to an iron pin set on the east line of the lands now owned by Chandlersville School Building Assoc. (OR 1641-985);

Thence with the common line of said Chandlersville School Building Assoc./Eck's lands the following two (2) courses:

1. N 09°39'28" E a distance of 122.75 feet to an iron pin found;
2. N 75°05'37" W a distance of 384.28 feet to an iron pin found on the east line of the lands now owned by David S. Eck & Jenny E. Eck (OR 2792-741);

Thence with the common line of said Eck/Eck's lands the following five (5) courses:

1. N 09°04'04" E a distance of 311.92 feet to an iron pin found;
2. N 82°48'26" W a distance of 736.28 feet to an iron pin found;
3. S 08°46'21" W a distance of 552.69 feet to an iron pin found;
4. S 81°03'33" W a distance of 158.88 feet to an iron pin found;
5. S 08°27'32" W a distance of 145.98 feet to an iron pin found on the north line of Chandlersville Road (SR-146);

Thence with the north line of said Chandlersville Road, N 81°07'29" W a distance of 316.44 feet to an iron pin found on the southeast corner of said Sears, Etal's lands;

Thence with the east line of said Sears, Etal's lands, N 01°49'48" E a distance of 440.68 feet to the principal place of beginning, containing a total of 23.983 acres more or less, subject to all legal highways and easements of record.

All bearings described herein are based on the Ohio State Plane Grid Coordinates, NAD83, Ohio South per GPS Observation.

All iron pins set are 5/8 inch by 30 inch steel rebar with plastic identification caps marked MCPEEK PS8517.

The above described 23.983 acre parcel is based on a field survey made by McPeek Land Surveying, LLC on February 5th 2018 and November 3rd 2021.

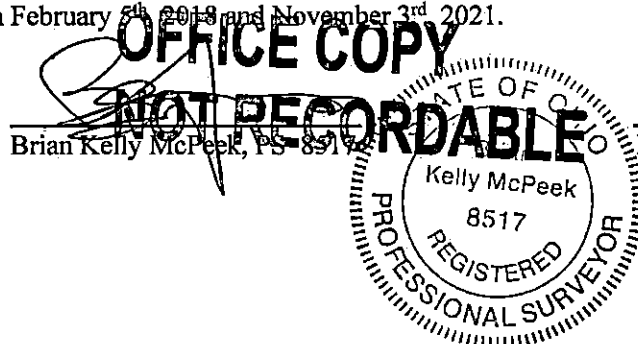

Date 12/1/21

DESCRIPTION
APPROVED
By: [Signature]