

62-01-01-05.009



Linn Engineering, Inc.

Civil Engineering Consultants

740-452-7434 • 1-800-991-7434

534 Market Street • P.O. Box 2086 • Zanesville, Ohio 43702-2086

Thomas C. and Tara K. Poorman

DR 1137-29

3.00 Acre Split

Situated in the State of Ohio, County of Muskingum, Township of Springfield, bounded and described as follows:

Being a part of Section 6, Township 16, Range 14, of the Congress Lands East of the Scioto River, and being part of the lands now owned by Thomas C. and Tara K. Poorman as recorded in Muskingum County Deed Record 1137-29, and being more particularly described as follows:

Beginning for reference at a concrete monument found at Centerline Station 1025+00 as recorded in the 1965 centerline survey of Interstate 70, Musk-70-(0.78)(1.43), page 2 of 29, as the same is designated and delineation on Muskingum County Plat Book 11, page 52;

thence South 87 degrees 00 minutes 54 seconds East 316.15 feet to a point on the centerline of Perine Road (CR-145), said centerline also being the Hopewell and Springfield township line;

thence along said centerline of Perine Road and township line, South 02 degrees 38 minutes 27 seconds West 995.05 feet to an iron pin set and the principal place of beginning;

thence through lands now owned by said Thomas C. and Tara K. Poorman (DR 1137-29), South 87 degrees 21 minutes 33 seconds East 468.30 feet to an iron pin set on the west line of lands now owned by James E. Dingey (OR 2453-542);

thence along said Dingey's west line, South 02 degrees 38 minutes 27 seconds West 264.44 feet to an iron pin found on the northeast corner of lands now owned by James F.

62-01-01-05-009 A

and Theresa M. Sheppard (DR 1114-459);

thence along Sheppards' north line, North 89 degrees 27 minutes 34 seconds West 111.81 feet to an iron pin found on Sheppards' northwest corner;

thence along Sheppards' west line, South 02 degrees 30 minutes 20 seconds West 212.74 feet to the centerline of Ridge Road (CR-34), passing an iron pin found at 191.65 feet;

thence along said centerline of Ridge Road, North 85 degrees 58 minutes 00 seconds West 15.36 feet to the southeast corner of lands now owned by Jennifer L. Ross (OR 2506-880);

thence along Ross's east line, North 02 degrees 35 minutes 18 seconds East 211.77 feet to an iron pin found on Ross's northeast corner, passing an iron pin found at 21.81 feet;

thence along said Ross's north line, North 89 degrees 26 minutes 58 seconds West 191.10 feet to an iron pin found on the northeast corner of lands now owned by William L. Snider (DR 1145-37);

thence along Snider's north line, North 87 degrees 22 minutes 41 seconds West 150.55 feet to the said centerline of Perine Road, passing an iron pin found at 119.79 feet;

thence along said centerline of Perine Road, North 02 degrees 38 minutes 27 seconds East 276.16 feet to the principal place of beginning;

containing 3.00 acres, more or less, subject to all legal road right of ways and applicable easements, written or implied.

Iron pins set are 5/8 inch diameter by 30 inch long rebar with plastic identification caps.

Bearings are based on Ohio State Plane Coordinate System, South Zone, NAD 83 as per GPS observations made June 24, 2014.

This description is written based on an actual field survey completed on July 10, 2014 by Timothy H. Linn, Reg. No. 7113.

OFFICE COPY
NOT RECORDABLE

Timothy H. Linn, Reg. No. 7113

Part of Parcel No. : 62-01-01-05-001 (3.00 ac.)

APPROVED
MUSKINGUM COUNTY
PLANNING COMMISSION DIRECTOR

8/11/14
Date

Fee Paid

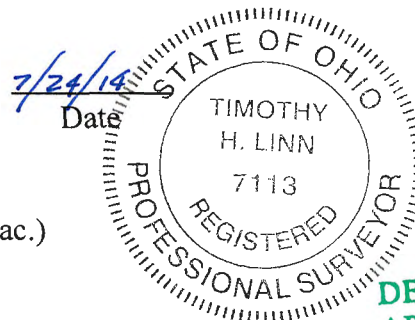

DESCRIPTION
APPROVED
By: *[Signature]*

62-01-01-05-009 B

DESCRIPTION
APPROVED

By: *[Signature]* 7/29/14

JAMES E. DINGEY
DR 2453 PG 542

CONCRETE MONUMENT AT
STATION 1025+00 OF THE 1965
CENTERLINE SURVEY OF
INTERSTATE 70 AS SHOWN ON
MUS-70-(0.78)(1.43) PG 2/29,
PLAT BOOK 11 PG 52.

ADAM M. & TARA L. PRITCHARD
DR 2278-521

CR-145
PERINE RD. 40' R/W

TROY A. & SUSAN BROCK
DR 1507-236

HOPWELL TWP.
SPRINGFIELD TWP.

THOMAS C. & TARA K. POORMAN
DR 1137 PG 29
+/-3.00 ACRES
Part of Parcel 62-01-01-05-001

30.76'

N 87°22'41" W

119.79'

WILLIAM L. SHODER
DR 1145 PG 37

N 89°26'58" W

191.10'

JENNIFER L. ROSS
DR 2506 PG 880

N 89°27'34" W

111.81'

JAMES F. & THERESA
M. SHEPPARD
DR 1114 PG 459

N 02°35'18" E 103.96'

S 02°30'20" W 191.65'

21.81'

21.09'

N 85°58'00" W

15.36'

RIDGE RD. (C.R.34) 40' R/W

Approved For Transfer
On Lot Sewage Proposed
Date 8/4/14

Zanesville-Muskingum County
Health Department

APPROVED
MUSKINGUM COUNTY
PLANNING COMMISSION DIRECTOR

8/11/14
Date

Fee Paid

BASIS OF BEARINGS

Bearings are based on the Ohio State Plane
Coordinate System, South Zone, NAD83 per GPS
observations on 06/24/14.

REFERENCES

DR 1137-29
DR 1105-385
DR 1145-37
DR 2506-880
DR 1114-459
PLAT BOOK 11, PG 52

SITUATED IN:

The State of Ohio, County of Muskingum,
Township of Springfield, and being part of
Section 6, T-16, R-14, Congress Lands East of
the Scioto River.

LEGEND

- Iron Pin Found
- ⊙ Iron Pin Set, 5/8" rebar
- Pipe Found
- ⊠ Concrete Monument Found
- ⊠ PPOB Principle Place of Beginning
- Centerline

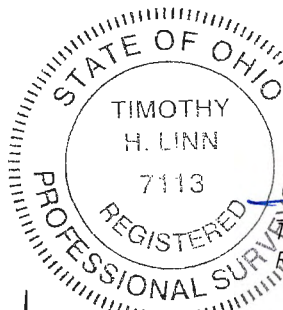
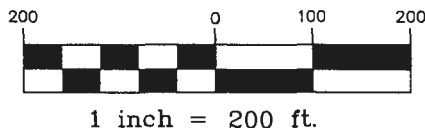

PARCEL No.

Part of: 62-01-01-05-001 ±3.00 ac.

**OFFICE COPY
NOT RECORDABLE**

7/24/14
Date



Linn Engineering, Inc.
Civil Engineering Consultants
P.O. Box 2086 Zanesville, Ohio 43702-2086

740-452-7434

G:\Survey\Plats\Muskingum\62 Springfield Twp\62-01-Poorman\62-01-Poorman.dwg, 7/24/2014 11:24:47 AM, 1:5