

LEGEND

- PIN (SET) 5/8" REBAR 30" LONG
- CAPPED (C/R) HARKNESS PS #6863
- PIN FOUND 5/8" REBAR UNLESS NOTED
- PIN FOUND CAPPED 7/24 C/S
- PIN FOUND CAPPED 5/792 GRAVES
- PIN FOUND CAPPED 5/718 BIEDENBACH
- STONE FOUND
- PIPE FOUND
- ⊗ AXLE
- △ POINT UNMARKED
- Z LANDHOOK

Brockway Glass Co. Inc.
DB Vol. 531, Page 298.

Situated in the State of Ohio, County of Muskingum, Township of Springfield:

SURVEY 1
Being part of the Northeast and Northwest Quarters, Section 11, Township 16, Range 14, of the Congress Lands East of the Scioto River, further being part of the Ray E Durant property recorded in **Deed Book Volume 748, Page 209** of said county's deed records, further being all of Muskingum County Auditor's Parcel Numbers 62-27-01-01-000 and 62-28-01-04-000.

SURVEY 2
Being part of the Northeast Quarter, Section 11, Township 16, Range 14, of the Congress Lands East of the Scioto River, further being part of the Ray E Durant property recorded in **Deed Book Volume 748, Page 209** of said county's deed records, further being all of Muskingum County Auditor's Parcel Number 62-28-01-05-000.

SURVEYOR'S NOTES AND REFERENCES:
Muskingum County Tax Maps and OGRIP Orthophotos of the area. All other references are shown or listed.
Note #1: Pipe shown on survey by Michael Lamano PS 7711 for the Columbia Gas Company. Not representative of prior division corner called for in division deed, not used.
Note #2: Pipe shown on survey by Michael Lamano PS 7711 for the Columbia Gas Company. Used considered original survey of division survey from DB 118, Page 10.
Note #3: Best fit approach used for the Columbia Gas Company property with occupation considered best evidence of original intent.
Note #4: Building with construction, long term use, by current owner Ray Durant. Gas company regulator building located in this area by the Lamano survey referenced as being shown on a 1971 survey (Not on File).
Note #5: Survey lines by Kevin Cannon PS 7224 of the Ray E Durant property dated 3/15/2012 were not used.
Note #6: Ridge Road right of way listed as 40 feet and Archer Lane is shown as assumed 40 feet.
Note #7: MET Data, State Plane Coordinates Ohio South 1983, 2011 Realization 2010.0 Epoch, GEOID18, GRS1980, Grid to Ground Scale Factor For surveyed portion of Section 11 - 1.00005068931358.

Bermudez Calls Survey 1					Bermudez Calls Survey 2				
CALL	BEARING	CHORD	ARC RADIUS	ARC LEN	CALL	BEARING	CHORD	ARC RADIUS	ARC LEN
1	S 87°10'05" E	1201.3'			1	S 87°10'05" E	1201.3'		
2	S 18°42'28" E	290.82'			2	S 18°42'28" E	290.82'		
3	S 72°53'10" W	18.67'			3	S 72°53'10" W	18.67'		
4	S 83°50'41" W	18.67'			4	S 83°50'41" W	18.67'		
5	S 83°50'41" W	18.67'			5	S 83°50'41" W	18.67'		
6	N 03°05'32" E	94.15'			6	N 03°05'32" E	94.15'		
7	S 73°04'18" W	25.91'			7	S 73°04'18" W	25.91'		
8	S 63°09'44" W	104.77'			8	S 63°09'44" W	104.77'		
9	N 04°14'57" E	367.69'			9	N 04°14'57" E	367.69'		
10	S 87°10'05" E	1201.3'			10	S 87°10'05" E	1201.3'		

Brockway Glass Co. Inc.
DB Vol. 531, Page 298.

Carol Moorehead
OR Vol. 2709, Page 472.

1,283 Acres
Ray E Durant
DB Vol. 748, Page 209.
Parcel Number
62-28-01-04-000

1,019 Acres
Ray E Durant
DB Vol. 748, Page 209.
Parcel Number
62-27-01-01-000

Total 2,302 Acres

Justin Sode & Jerry Sode
OR Vol. 2899, Page 49.

Rebecca L. Keiso
OR Vol. 2746, Page 580.

Wilbur Jay Huggins
& Cathy J Huggins
OR Vol. 2986, Page 82.

Siron Rentals LLC
OR Vol. 2896, Page 304.

Archer Lane

Ridge Rd

Ridge Rd

Perimeter Calls Survey 2					Perimeter Calls Survey 1				
CALL	BEARING	CHORD	ARC RADIUS	ARC LEN	CALL	BEARING	CHORD	ARC RADIUS	ARC LEN
1	N 03°05'32" E	238.13'			1	N 03°05'32" E	238.13'		
2	N 87°01'40" W	338.66'			2	N 87°01'40" W	338.66'		
3	N 83°50'41" E	48.94'			3	N 83°50'41" E	48.94'		
4	N 72°07'22" E	38.09'			4	N 72°07'22" E	38.09'		
5	S 11°36'37" E	430.17'			5	S 11°36'37" E	430.17'		
6	S 87°01'40" W	338.66'			6	S 87°01'40" W	338.66'		
7	N 03°05'32" E	238.13'			7	N 03°05'32" E	238.13'		

2.249 Acres

Ray E Durant
DB Vol. 748, Page 209.
Parcel Number
62-28-01-05-000

J. B. Owens Addition
Plat Book 2, Page 111

S 03°05'32" W 2097.69'
To Pin Found at Center of Section

APPROVED
12/13/2025

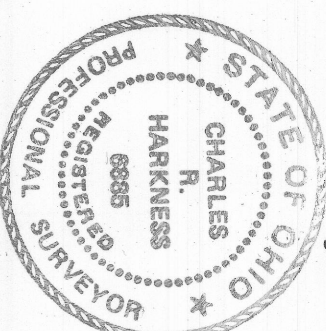

This plat was prepared by C.R. Harkness Surveying & Mapping Inc. in accordance with Chapter 4733-37 of the Administrative Code, and is intended to be used for the legal transfer of the parcel surveyed and does not show any apparent easements or encumbrances, unless otherwise indicated.

Charles R. Harkness PS #6863

SURVEY FOR:

Ray E Durant

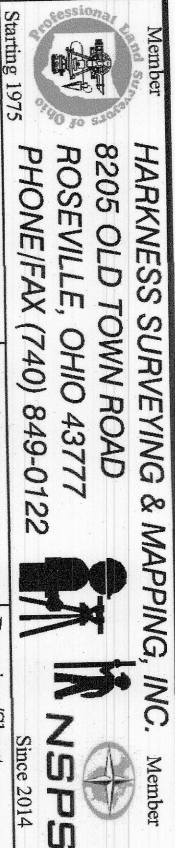

DRAWN: 12/19/24

SURVEYED: 12/13/24