

DESCRIPTION OF SURVEY FOR FREDA M PARSONS

JOB#2011

Situated in the State of Ohio, County of Muskingum, Township of Springfield:

Being part of Northwest Quarter, Section 14, Township 16, Range 14, of the Congress Lands East of the Scioto River, further **being all of** the Freda M Parsons property recorded in Official Record Volume 2410, Page 508, of said county's deed records, further **being all of** Muskingum County Auditor's Parcel Numbers **62-48-01-46-000, and 62-48-01-47-001**, and more particularly described as follows;

Commencing at an iron pin (found) at the Southwest corner of Lot 5 of Hideaway Acres recorded in Plat Book 10, Page 20, also being the Northwest corner of the Tommy E Tipton and Debra S Tipton property recorded in Deed Book Volume 784, Page 115, further being on the East line of a private road Stalder Drive, and property line of Jacquelyn M Smith property recorded in Official Record Volume 2325, Page 779;

- TIE-1 THENCE South 02 degrees 23 minutes 15 seconds West 183.80 feet** along the common line for said Tipton and Smith properties, also the East line of said private road to the unmarked common corner of said Tipton property and for the Ermina E McElroy property recorded in Official Record Volume 2410, Page 508;
- TIE-2 THENCE South 04 degrees 01 minutes 45 seconds West 275.52 feet** along the said McElroy and Smith properties, East line of said private road, also the East line of the Chad A James and Billie J James property recorded in Official Record Volume 2125, Page 204 to an iron pipe (found), passing an iron pipe (found) at 66.86 feet;
- TIE-3 THENCE South 87 degrees 15 minutes 55 seconds East 170.95 feet** continuing along said McElroy and James properties to an iron pipe (found) at a common corner for the Michael L Jacolenne and Theresa Jacolenne property recorded in Official Record Volume 1511, Page 706;
- TIE-4 THENCE South 02 degrees 45 minutes 40 seconds West 246.74 feet** continuing along James and Jacolenne properties, also along the Vincent E Finck and Kathleen Finck property recorded in Official Record Volume 1635, Page 395 and the Todd A Sidwell and Christine K Sidwell property recorded in Deed Book Volume 1157, Page 865 to the unmarked place of beginning for the property herein intended to be described, passing iron pipes (found) at 70.00 feet and 104.87 feet;
- #1- THENCE South 76 degrees 19 minutes 35 seconds East 443.88 feet** along said Parsons and Finck properties to an iron pin (found), passing an iron pin (found) at 1.61 feet;
- #2- THENCE North 84 degrees 41 minutes 40 seconds East 158.03 feet** continuing along said Parsons and Finck properties to an unmarked point in the centerline of Potts Lane, passing an iron pin (found) at 133.03 feet;
- #3- THENCE South 21 degrees 57 minutes 00 seconds West 271.63 feet** along said Potts Lane to the Northeast corner of the Thomas M Shaeffer and Cathy J Shaeffer property recorded in Deed Book Volume 1074, Page 280;
- #4- THENCE North 67 degrees 44 minutes 10 seconds West 533.66 feet** along said Parsons and Shaeffer properties to an iron pin (set) on the East line of the Todd A Sidwell and Christine K Sidwell property recorded in Official Record Volume 1510, Page 58;
- #5- THENCE North 02 degrees 45 minutes 40 seconds East 140.24 feet** along said Parsons and Sidwell properties to the place of beginning, passing an axle (found) at 100.00 feet, containing 1.65 acres being Parcel Number 62-48-01-46-000 and 0.71 acres being Parcel Number 62-48-01-47-001 for a **total of 2.36 acres**, of which 0.12 acres are within the right of way for Potts Lane.

The bearings within this description are based on State Plane Coordinate Grid (Ohio South 1983) derived from GPS Observations. Iron pins (set) are 5/8" rebar with identification caps (C.R.Harkness P.L.S.6885).

This description was written by Charles R. Harkness Professional Land Surveyor #6885 from an actual survey completed on October 17, 2012 in accordance with Chapter 4733-37 of the Administrative Code, and is intended to be used for the legal transfer of the property described and does not intend to describe all or any easements of record, unless otherwise indicated.

OFFICE COPY
NOT RECORDABLE
Charles R. Harkness P.L.S. #6885

DESCRIPTION
APPROVED

By: *[Signature]* 10/17/12

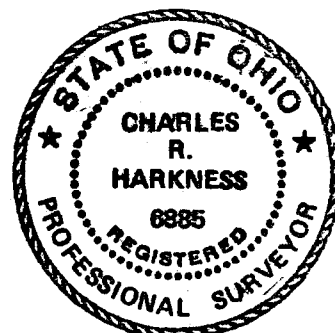

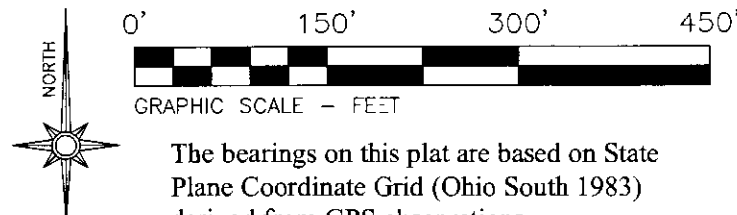

LEGEND

- PIN (SET) 5/8" REBAR CAPPED (C R HARKNESS PLS#6885)
- PIN (FOUND)
- △ POINT (UNMARKED)
- PIPE (FOUND)
- ⊗ AXLE (FOUND)
- ▲ SURVEY STAKE (FOUND)

The bearings on this plat are based on State Plane Coordinate Grid (Ohio South 1983) derived from GPS observations.

Situated in the State of Ohio, County of Muskingum, Township of Springfield:

Being part of the Northwest Quarter, Section 14, Township 16, Range 14, of the Congress Lands East of the Scioto River, further being the Freda M Parsons property recorded in Official Record Volume 2282, Page 549 of said county's deed records, further being all of Muskingum County Auditor's Parcel Numbers 62-48-01-46-000 and 62-48-01-47-001:

SURVEYOR'S NOTES AND REFERENCES:

Muskingum County Tax Maps and Orthophotos of the area. Survey completed by Charles R Harkness PLS #6885 (Job 2010 dated 10/17/2012) of the Ermina E McElroy property.

Note #1- Properties East of Potts Lane are shown for graphical purposes only and were not surveyed and were located by county tax map and GIS information.

Note #2- Right of way listed at the Muskingum County Engineer's Office for Potts Lane is 40 feet.



This plat was prepared by C.R. Harkness Surveying & Mapping Inc. in accordance with Chapter 4733-37 of the Administrative Code, and is intended to be used for the legal transfer of the parcel surveyed and does not show all or any easments of record, unless otherwise indicated.

Charles R. Harkness
Charles R. Harkness PLS #6885

SURVEY FOR:		HARKNESS SURVEYING & MAPPING, INC.	
Freda M Parsons		8205 OLD TOWN ROAD	
		ROSEVILLE, OHIO 43777	
		PHONE/FAX (740) 849-0122	
SURVEYED:10/17/12		JOB NUMBER	DRAWING / SHEET #
DRAWN:10/18/12		Job#2011	Plat #01

