

TERRY FINLEY
Surveying & Mapping
Ohio Registered Surveyor #S-7222
155 Mockingbird Hill, Zanesville, OH 43701
Phone or FAX (740) 454-8721

LEGAL DESCRIPTION
2590 Pinkerton Road, Zanesville, OH 43701

Situated in the State of Ohio, County of Muskingum, Township of Springfield, and being part of the northeast quarter of Section 3, Township 15, Range 14, and being all those lands intended to be described in Deed Volume 355, page 346; being further bounded and described as follows:

Commencing at the southeast corner of the northeast quarter of said Section 3, thence, north 90 degrees – 00 minutes – seconds west, 1990.70 feet to a point; thence, north 00 degrees – 00 minutes – 00 seconds east, 485.25 feet to a point in Pinkerton Road; thence, south 55 degrees – 59 minutes – 26 seconds east, 117.30 feet, along said road, to the **true point of beginning** for the parcel herein intended to be described;

Thence, leaving Pinkerton Road and along the east line of those lands now or formerly owned by C.A. & T.A. Wigal (1157/730), **north 05 degrees – 51 minutes – 30 seconds east, 372.59 feet** to an iron pin found, passing an iron pin found at 21.25 feet;

Thence, **south 78 degrees – 49 minutes – 16 seconds east, 130.43 feet**, along the southerly line of those lands now or formerly owned by J.M. & C.L. Sheppard (1103/8), to an iron pin found;

Thence, **south 13 degrees – 48 minutes – 34 seconds west, 408.20 feet**, along the westerly line of said Sheppard lands, to a point in Pinkerton Road, passing an iron pin found at 387.20 feet;

Thence, **north 53 degrees – 19 minutes – 37 seconds west, 85.47 feet**, along said road, to the **point of beginning**, and **containing 0.924 acres more or less**.

Included herein is the following described **twenty (20) foot wide ingress/egress easement** as described in Official Record 1535, page 797, the centerline thereof being described as follows: Commencing at the southeast corner of the above-described 0.924 acre parcel, thence, north 53 degrees – 19 minutes – 37 seconds west, 18.35 feet to a point in Pinkerton Road, and the true point of beginning for said centerline; thence, north 25 degrees – 05 minutes – 24 seconds east, 87.33 feet to a point on the east line of above-described 0.924 acre parcel and the terminus of this easement;

Subject to all legal highways and easements, whether recorded or implied.

Iron pins set are 5/8 rebar with yellow identification cap (FINLEY S-7222).

Bearings described herein are based on assumed azimuth and to be used for angle purposes only.

Being all of Auditor's Parcel #62-68-02-16-000.

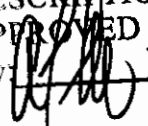
DESCRIPTION
APPROVED
By:  7/15/2010



This description, written on July 8, 2010, is based on an actual survey by Terry J. Finley, Ohio Registered Surveyor #S-7222

Terry J Finley, Registered Surveyor #S-7222

**NOTICE COPY
NOT RECORDABLE**

SITUATED IN THE STATE OF OHIO, COUNTY OF MUSKINGUM, TOWNSHIP OF SPRINGFIELD AND BEING PART OF THE NE. QTR. SECTION 3, T-15, R-14. BEING ALL THOSE LANDS INTENDED TO BE DESCRIBED IN DEED VOLUME 355, PAGE 346.

BEING ALL OF AUDITOR'S PARCEL NO. 62-68-02-16-000.

THE BEARINGS SHOWN HEREON ARE BASED ON ASSUMED AZIMUTH AND USED FOR ANGLE PURPOSES ONLY.



0 30 60
SCALE: 1"=60'

C.A. AND T.A.
WIGAL 1157/730

0.924 AC.

DESCRIPTION
APPROVED
By: *[Signature]* 7/15/2010

J.M AND C.L.
SHEPPARD 1103/8

LEGEND: IRON PIN FOUND ●
POINT ▲

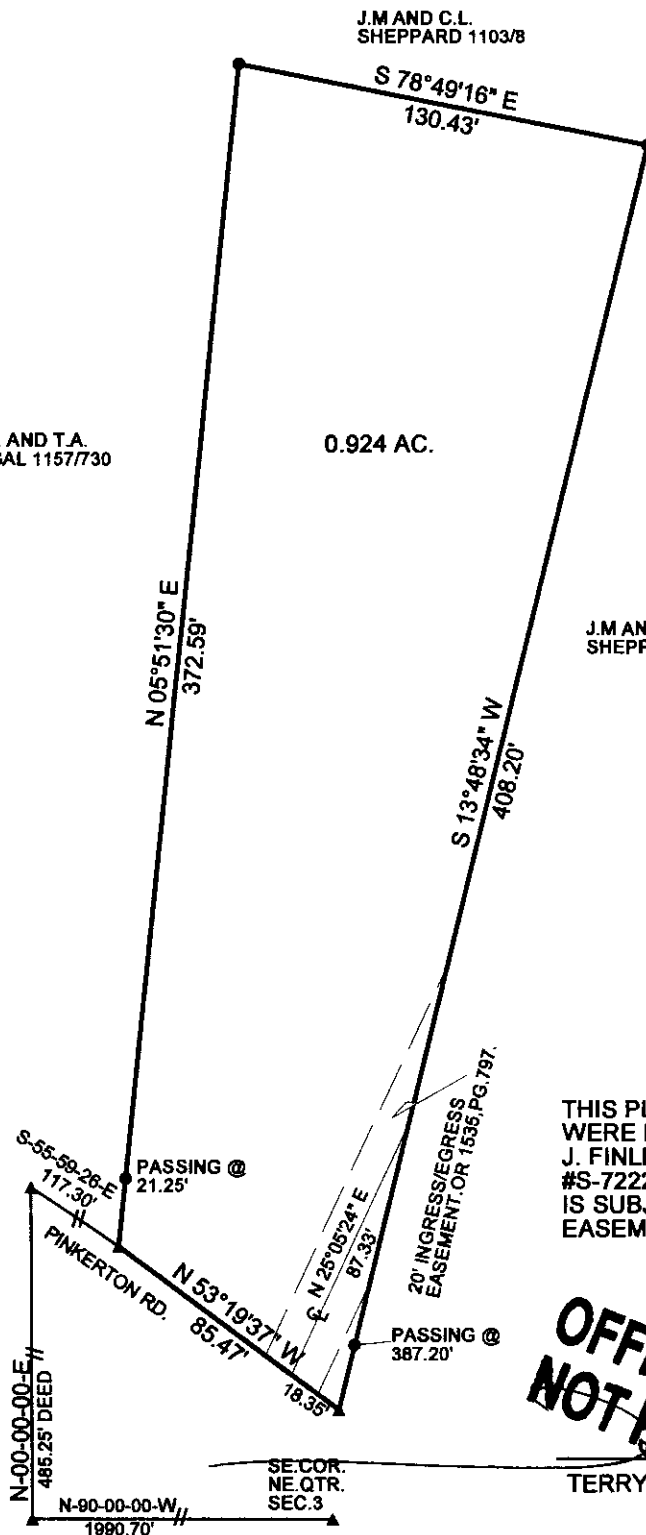

THIS PLAT AND ACCOMPANYING DESCRIPTION WERE PREPARED ON JULY 8TH, 2010 BY TERRY J. FINLEY, OHIO REGISTERED SURVEYOR #S-7222 BASED ON AN ACTUAL SURVEY AND IS SUBJECT TO ALL LEGAL HIGHWAYS AND EASEMENTS, RECORDED OR IMPLIED.

OFFICE COPY
NOT RECORDABLE
TERRY J. FINLEY

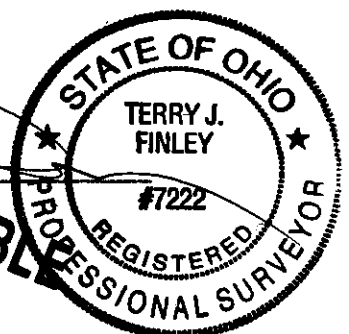

TERRY J. FINLEY SURVEYING

155 MOCKINGBIRD HILL

ZANESVILLE, OHIO 43701

DATE: 7/08/2010

SCALE: 1" = 60'

DRAWN BY: TJF