

Situated in the State of Ohio, County of Muskingum, Township of Springfield:

Being part of the Northwest Quarter, of Section #1, known as Muskingum County Auditor's Parcel Number 62-74-01-03-000, and part of the Northeast Quarter, of Section #2, known as Muskingum County Auditor's Parcel Number 62-72-03-01-000, both Sections are within, Township #15, Range #14, of the Congress Lands East of the Scioto River, being part of the Kelly J & Erin K Cottrill property recorded in Official Record Volume 1658, Page 842 of said county's deed records, and more particularly described as follows:

Commencing at the unmarked common corner for the Northwest and Southwest Quarters of said Section #1 and for the Northeast and Southeast Quarters of Section #2, also being within the roadbed of Greenhouse Road (Township Road #46); **THENCE North 03 degrees 04 minutes 00 seconds East 620.75 feet** leaving said road, along the common line for said Sections #1 & #2, and through said Cottrill property to an iron pin (set) at the place of beginning for the property herein intended to be described;

- #1- **THENCE South 55 degrees 47 minutes 00 seconds West 26.69 feet** into said Section #2 and continuing through said Cottrill property to an iron pin (set);
- #2- **THENCE North 19 degrees 06 minutes 15 seconds West 440.06 feet** continuing through said Cottrill property to an iron pin (set);
- #3- **THENCE North 10 degrees 44 minutes 00 seconds East 64.72 feet** continuing through said Cottrill property to an iron pin (set);
- #4- **THENCE North 75 degrees 10 minutes 26 seconds West 138.66 feet** continuing through said Cottrill property to an unmarked point in the roadbed of Shaw Road (Township Road #261), passing an iron pin (set) at 120.36 feet;
- #5- **THENCE North 36 degrees 37 minutes 26 seconds East 49.18 feet** along said road and common line for said Cottrill property and for the Muskingum County Library property recorded in Deed Book 1119, Page 189 to an unmarked point on the South right of way for Maysville Pike (US Route #22);
- #6- **THENCE South 38 degrees 29 minutes 30 seconds East 23.80 feet** leaving said Shaw Road and along said South right of way for US Route #22 to an iron pin (found);
- #7- **THENCE North 43 degrees 04 minutes 20 seconds East 147.06 feet** continuing along said South right of way to an iron pin (found);
- #8- **THENCE North 84 degrees 04 minutes 15 seconds East 23.08 feet** continuing along said South right of way to an iron pin (found);
- #9- **THENCE North 24 degrees 58 minutes 50 seconds East 21.74 feet** continuing along said South right of way to a survey nail (set);
- #10- **THENCE South 88 degrees 06 minutes 45 seconds East 263.73 feet** leaving said right of way and through said Cottrill property and crossing into said Section #1, to an iron pin (set), passing an iron pin (set) on said Section line at 146.02 feet;
- #11- **THENCE along a curve to the right having, a chord bearing South 47 degrees 23 minutes 35 seconds East 272.69 feet**, a radius of 209.00 feet, and arc length of 297.08 feet, continuing through said Cottrill property to an iron pin (set);
- #12- **THENCE South 06 degrees 40 minutes 20 seconds East 119.50 feet** continuing through said Cottrill property to an iron pin (set);
- #13- **THENCE along a curve to the right having, a chord bearing South 24 degrees 33 minutes 20 seconds West 141.68 feet**, a radius of 136.64 feet, and arc length of 148.95 feet, continuing through said Cottrill property to an iron pin (set);
- #14- **THENCE South 55 degrees 47 minutes 00 seconds West 372.38 feet** continuing through said Cottrill property to the place of beginning, containing 3.80 acres from Section #1 and 2.24 acres from Section #2 for a **total of 6.04 acres**.

The bearings within this description are based on State Plane Coordinate Grid (Ohio South 1983) derived from GPS Observations. Iron pins (set) are 5/8" rebar with identification caps (C.R.Harkness P.L.S.6885).

This description was written by Charles R. Harkness Professional Land Surveyor #6885 from an actual survey completed on September 2, 2005, in accordance with Chapter 4733-37 of the Administrative Code, and is intended to be used for the legal transfer of the property described and does not intend to describe all or any easements of record, nor encroachments unless otherwise indicated.

APPROVED FOR CLOSURE

Charles R. Harkness 9-8-2005



OFFICE COPY
NOT RECORDABLE
Charles R. Harkness P.L.S. 6885

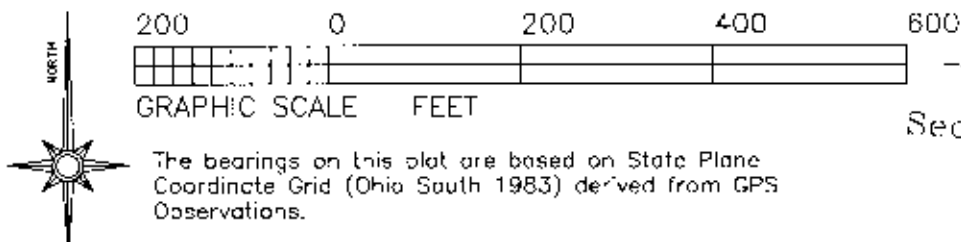

Situated in the State of Ohio, County of Muskingum, Township of Springfield:
Being part of the Northwest Quarter, of Section #1, known as Muskingum County Auditor's Parcel Number 62-74-01-03-000, and part of the Northeast Quarter, of Section #2, known as Muskingum County Auditor's Parcel Number 62-72-03-01-000, both Sections are within, Township #15, Range #4, of the Congress Lands East of the Scioto River, being part of the Kelly J & Erin K Cottrill property recorded in Official Record Volume 1658, Page 842 of said county's deed records;

SURVEYOR'S NOTES & REFERENCES:

Muskingum Co. Tax Maps and Orthophotos of the area, 3-D TopoQuads by DeLorme (Ohio).
Right of way plans US Route #22,
Note #1- Centerline of Shaw Road as per survey completed by R I Daniels PLS #5410 dated 5/15/1997.
Note #2- Section line is shown per monuments shown. This line does not coincide with several different locations per deeds of the area and the right of way plans for US Route #22.

This plat was prepared by C. R. Harkness Surveying & Mapping, Inc. in accordance with Chapter 4733-37 of the Administrative Code, and is intended to be used for the legal transfer of the property described and does not intend to describe all or any easements of record, nor encroachments unless otherwise indicated.

**OFFICE COPY
NOT RECORDABLE**

Approved For Transfer
No On-Lot Sewage
9/13/2005 Date
M. J. Harkness

Muskingum Co. Library
DB Vol. 113, Page 189.
Zanesville - Muskingum Co.
Health Department

Z-Town Development Co.
DB Vol. 1137, Page 752.

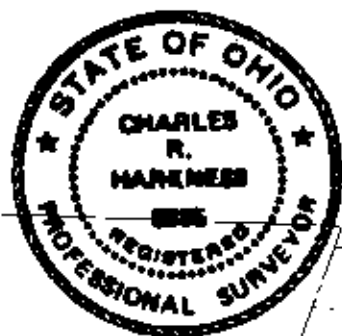

SURVEY FOR:	
KELLY & ERIN COTTRILL	
SHAW ROAD, ZANESVILLE, OHIO 43701	
SURVEY DATE: 9/2/2005	DRAWN DATE: 9/3/2005
SEC. #1 & #2 TWP. #15 R. #14 TWP. Springfield CO: Muskingum	
CHARLES R. HARKNESS SURVEYING & MAPPING, INC. 8205 OLD TOWN ROAD ROSEVILLE, OHIO 43777 PHONE (740) 849-0122	
JOB NUMBER	DRAWING / SHEET NUMBER
JOB #1427	Plat #02

Sec #2 Sec #1
APPROVED FOR CLOSURE
9-2-2005
LEGEND

- PIN (SET) 5/8" REBAR CAPPED (C R HARKNESS P. 546285)
- PIN (FOUND)
- △ POINT (UNMARKED)
- ⊠ AXLE (FOUND)
- ⊙ SURVEY NAIL (SET)

APPROVED
MINOR LOT SPLIT ONLY
MUSKINGUM COUNTY
PLANNING COMMISSION
9-14-2005
Date

Fee Paid

