

DESCRIPTION OF SURVEY FOR ELAINE VIRGINIA SHAFER

JOB#2077

Situated in the State of Ohio, County of Muskingum, Township of Springfield:

Being part of the Northeast Quarter, Section 1, Township 15, Range 14, of the Congress lands East of the Scioto River, further **being all of** the Elaine Virginia Shafer property recorded in Deed Book Volume 518, Page 648 of said county's deed records, further **being all of** Muskingum County Auditor's **Parcel Number 62-76-02-02-000**, and more particularly described as follows;

Commencing at a stone (found) at the common corner for said Section 1 and for Section 5 of Township 11, Range 13, for Section 15 of Township 12, Range 13, and for Section 13 of Township 16, Range 14 of said Congress Lands;

- TIE- THENCE North 85 degrees 06 minutes 29 seconds West 99.46 feet** along the common line for Sections 1 and 13 and along the South Zanesville Corporation Line to an iron pipe (found) at a common corner for said Shafer property and for the Roy Alfred Sands and Helen Ione Sands Trustees property recorded in Official Record Volume 2242, Page 716, further being the place of beginning for the property herein intended to be described;
- #1- THENCE South 03 degrees 08 minutes 05 seconds West 184.96 feet** into Section 1, and along said Shafer and Sands properties to an iron pipe (found) on the North line of Grandview Street;
- #2- THENCE along a curve to the left having, a chord bearing South 76 degrees 47 minutes 30 seconds West 91.00 feet, a radius of 208.57 feet, and arc 91.74 feet** along Grandview Street to an axle (found) at a common corner for said Shafer property and for the Samuel C Lovejoy III property recorded in Official Record Volume 1971, Page 714 ;
- #3- THENCE North 01 degrees 54 minutes 04 seconds East 213.44 feet** leaving Grandview Street and along said Shafer and Lovejoy properties to an axle (found) on the common line for said Sections 1 and 13;
- #4- THENCE South 85 degrees 06 minutes 29 seconds East 91.96 feet** along said Section line to the place of beginning, **containing 0.40 acres.**

The bearings within this description are based on State Plane Coordinate Grid (Ohio South 1983) derived from GPS Observations. Iron pins (set) are 5/8" rebar with identification caps (C.R.Harkness P.L.S.6885).

This description was written by Charles R. Harkness Professional Land Surveyor #6885 from an actual survey completed on July 10, 2013 in accordance with Chapter 4733-37 of the Administrative Code, and is intended to be used for the legal transfer of the property described and does not intend to describe any apparent easements nor easements of record, unless otherwise indicated.

OFFICE COPY
NOT RECORDABLE
Charles R. Harkness P.L.S. #6885

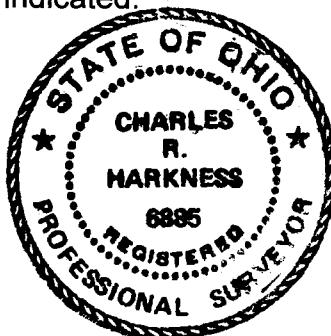

DESCRIPTION
APPROVED

By: [Signature] 7/15/2013

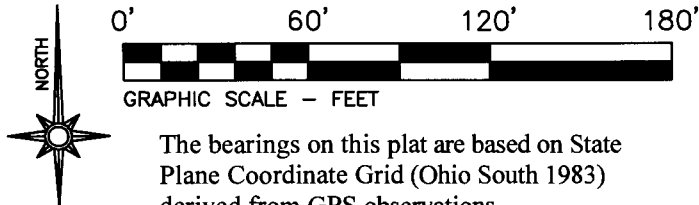

LEGEND

- PIN (FOUND) ● PIPE (FOUND)
- ⊠ STONE (FOUND MARKED)
- ⊠ AXLE (FOUND) ▲ UNMARKED POINT

Situated in the State of Ohio, County of Muskingum, Township of Springfield:

Being part of the Northeast Quarter, Section 1, Township 15, Range 14, of the Congress Lands East of the Scioto River, further being all of the Elaine Virginia Shafer property recorded in Deed Book Volume 518, Page 648 of said county's deed records, further being all of Muskingum County Auditor's Parcel Number 62-76-02-02-000:

SURVEYOR'S NOTES AND REFERENCES:

Muskingum County Tax Maps and Orthophotos of the area.
Note #1- Sally Drive, Grandview Street and Extension of Albert Drive were created by deed.

This plat was prepared by C.R. Harkness Surveying & Mapping Inc. in accordance with Chapter 4733-37 of the Administrative Code, and is intended to be used for the legal transfer of the parcel surveyed and does not show any apparent easements nor easements of record, unless otherwise indicated.

OFFICE COPY
NOT RECORDABLE

Charles R. Harkness PLS #6885

DESCRIPTION
APPROVED
By: [Signature] 7/10/13



Sally Drive (By Deed)

Section 13 Twp 16 Range 14
Section 1 Twp 15 Range 14
South Zanesville Corp Line

Everett C Kerby & Kristi Kerby
DB Vol. 1110, Page 161.

Jack S Spangler
& Joy L Spangler
DB Vol. 742,
Page 274.

**Sec 13
Twp 16
Rg 14**

**Sec 15
Twp 12
Rg 13**

Commencing
**Sec 1
Twp 15
Rg 14**

**Sec 5
Twp 11
Rg 13**

Roy Alfred Sands &
Helen Ione Sands
Trustees
OR Vol. 2242,
Page 716.

Elden A Kinnan II
& Renae L Kinnan
OR Vol. 2084, Page 124.

0.40 Acres

Elaine Virginia Shafer
DB Vol. 518, Page 648.
Auditor's Parcel Number
62-76-02-02-000.

Curve Left
Chord Bearing
S 63°20'50" W 6.15'
R=208.57' A=6.15'

A=91.74'
R=208.57'
S 76°47'30" W 91.00'

Grandview Street (By Deed)

Additional RW (By Deed)

Robert M Neff
OR Vol. 2246, Page 421.

Gregory R Carter
OR Vol. 2302,
Page 236.

Section 13 Twp 16 Range 14
Section 1 Twp 15 Range 14

SURVEY FOR:		HARKNESS SURVEYING & MAPPING, INC.	
Elaine V Shafer		8205 OLD TOWN ROAD ROSEVILLE, OHIO 43777 PHONE/FAX (740) 849-0122	
SURVEYED: 7/10/13	DRAWN: 7/10/13	JOB NUMBER Job#2077	DRAWING / SHEET # Plat #01