

James R. Sturtz (OR 1102-137) North 15 degrees 33 minutes 47 seconds West 18.94 feet to a point, an iron pipe found bearing North 74 degrees 46 minutes 03 seconds East 0.20 feet;

thence continuing along a line of James R. Sturtz (OR 1102-137) North 15 degrees 33 minutes 47 seconds West 145.70 feet to an iron pipe found on a line of the New Concord Bible Church, Inc. (DR 892-115);

thence leaving the line of James R. Sturtz (OR 1102-137) and along the New Concord Bible Church, Inc. (DR 892-115) North 63 degrees 16 minutes 20 seconds East 230.87 feet to an iron pipe found;

thence along another line of New Concord Bible Church, Inc. (DR 892-115) South 86 degrees 58 minutes 03 seconds East 373.18 feet to an iron pipe found beside an existing stone on the east line of Section 9;

thence leaving the New Concord Bible Church, Inc. (DR 892-115) and along the east line of Section 9 South 01 degrees 32 minutes 42 seconds West 264.08 feet to the place of beginning containing 6.49 acres, more or less,

NOTES:

Access to the Crooked Creek Cemetery is across the drive along the northeast line of James R. Sturtz (OR 1102-137) property.

All of Parcel No.:	66-66-20-09-27-000 (\pm 3.19 acres)
All of Parcel No.:	66-66-20-09-28-000 (\pm 2.10 acres)
All of Parcel No.:	66-66-20-10-29-000 (+ 1.20 acres)
TOTAL 6.49 ACRES	

SWR

Iron pins set are 5/8 inch rebar 30 inches long with identification caps ("MUSK CTY" "SWIERZ 8062"). This legal description was written by Denis P. Swierz based on a field survey completed November 2007 by Muskingum County Engineers' Office. The bearings in this description are based on NAD 83, Ohio South Zone, State Plane coordinates as per GPS Observations from Muskingum County Engineer GPS monument - GPS 88.

Subject to all easements, right of ways, restrictions, reservations, etc., of record and as the same may be implied.

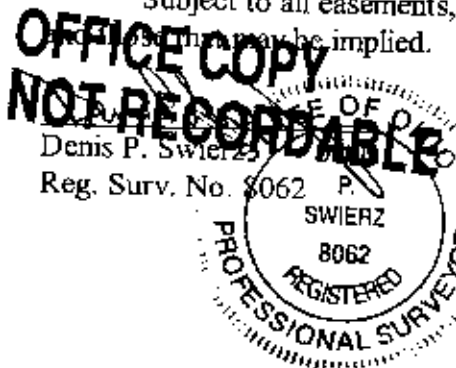

12/03/07

Date

APPROVED FOR CLOSURE

[Signature] 12/19/07

EXEMPT FROM
PLANNING COMMISSION

[Signature] 12/19/07