

W. J. Biedenbach & Associates

SURVEYING & MAPPING
3120 LISA LANE
ZANESVILLE OHIO 43701
(614) 453 4850

Being a part of Lot number 17 of W. I. Miller's 1st Addition to the Village of New Concord, as recorded in Plat Book 4 page 103 of the Muskingum County Plat Records, situated in the South West Quarter of Section 1 Township 1, Range 5 of the United States Military Lands, Village of New Concord, County of Muskingum, State of Ohio and being further described as follows:

Commencing at the South East corner of Lot number 18 of said W. I. Miller's 1st Addition; thence North 85 degrees 11 minutes 00 seconds West 283.50 feet along the South line of said Lot number 18 to a point marked by an existing iron pin (3/4 inch i.d. pipe), passing a point marked by an existing iron pin (3/4 inch i.d. pipe) at 233.50 feet; thence North 02 degrees 38 minutes 40 seconds West 138.96 feet to a point marked by an existing iron pin (3/4 inch i.d. pipe) on the South line of West Thompson Ave (North line of Lot number 18); thence North 03 degrees 24 minutes 02 seconds East 36.50 feet to a point on the North line of West Thompson Ave (the south line of Lot number 17), said point being the place of beginning of this tract; thence North 86 degrees 35 minutes 58 seconds West 40.51 feet along the North line of West Thompson Avenue to a point marked by an iron pin set (3/4 inch i.d. x 30 inches long iron pin); thence North 03 degrees 22 minutes 18 seconds East 150.78 feet to a point marked by an existing iron pin (3/4 inch solid rod) on the South line of a sixteen foot alley; thence South 86 degrees 05 minutes 11 seconds East 53.97 feet along the said sixteen foot alley to a point marked by an existing iron pin (3/4 inch i.d. pipe); thence South 03 degrees 21 minutes 37 seconds West 150.29 feet to a point marked by an iron pin set (3/4 inch i.d. x 30 inches long iron pipe) ON THE North line of West Thompson Avenue; thence North 86 degrees 35 minutes 58 seconds West 13.49 feet along the said North line of West Thompson Avenue to the place of beginning.

Containing 0.187 more or less acres. Previous deed Reference Volume 487 page 489. Bearings are based on the survey and description of the 2.08 more or less acres tract conveyed to John W. Mathes, etal (Volume 558 page 747)

I hereby certify the above description to be correct as prepared by me, this 7th day of March 1984.

W. J. B.
W. J. BIEDENBACH
REG. SURVEYOR 5718
HGT (Linkhorn)
1488-2-84



James A. Linkhorn

- ~ Existing Iron Pin
- ⊙ ~ Iron Pin Set (Widex 30" long iron pipe)

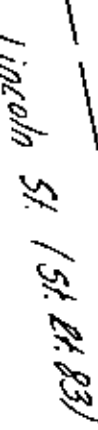

I hereby certify the above plat and survey to be correct as prepared by me, this 7th day of March 1984.

me, this 7th day of March
W. J. EDENBACH
REG. SURVEYOR #5718

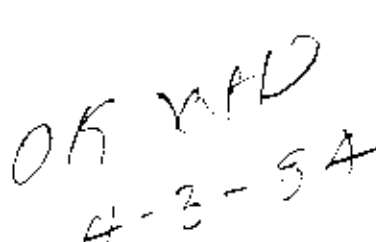
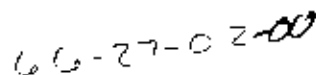

Drawn by: MD	Date: 3-6-84
Scale: 1"=50'	Checked by: MD
1-A 10' x 10' x 10'	100' (100' x 100')

W. J. Biedenbach & Associates

SURVEYING & MAPPING
3120 USA LANE
ZANESVILLE, OHIO 43701
(614) 453 4850

66-27-02-00

Union

Being a part of Lot number 17 of W. I. Miller's First Addition to the Village of [REDACTED] as recorded in Plat Book 4 page 103 of the Muskingum County Plat Records, situated in the South West Quarter of Section 1 Township 1, Range 5 of the United States Military Lands, Village of New Concord, County of Muskingum, State of Ohio and being further described as follows:

Commencing at the South East corner of Lot number 18 of said W. I. Miller's First Addition; thence North 85 degrees 11 minutes 00 seconds West 283.50 feet along the South line of said Lot number 18 to a point marked by an existing iron pin (3/4 inch i.d. pipe), passing a point marked by an existing iron pin (3/4 inch i.d. pipe) at 233.50 feet; thence North 02 degrees 38 minutes 40 seconds West 138.96 feet to a point marked by an existing iron pin (3/4 inch i.d. pipe) on the South line of West Thompson Ave (North line of Lot number 18); thence North 03 degrees 24 minutes 02 seconds East 36.50 feet to a point on the North line of West Thompson Avenue (the South line of Lot number 17), thence North 86 degrees 35 minutes 58 seconds West 40.51 feet to a point marked by a 3/4 inch iron pipe set, said point being the place of beginning of this tract; thence North 86 degrees 35 minutes 58 seconds West 54.00 feet along the North line of Thompson Avenue to a point marked by a 3/4 inch iron pipe set; thence North 03 degrees 22 minutes 18 seconds East 150.78 feet to a point marked by a 3/4 inch iron pipe set; thence South 86 degrees 35 minutes 58 seconds East 54.00 feet to a point marked by a 3/4 inch solid rod; thence South 03 degrees 22 minutes 18 seconds West 150.78 feet to the place of beginning.

Containing 0.187 more or less acres, subject to all easements of record.

I hereby certify the above description to be correct as prepared by me, this 20th day of April 1984.

WJ
W. J. BIEDENBACH
REG. SURVEYOR #5718

Shegog 1551-4-84



*OK'd
4/30/84*

*B Stubbs
4/30/84*

UR

Citation of Pertinent Documents
Deed—Vol. 487 Pg. 489
Plat—P. B. 4 Pg. 103
Musk. Co. Tax Map (sh. 13 New
Concord)

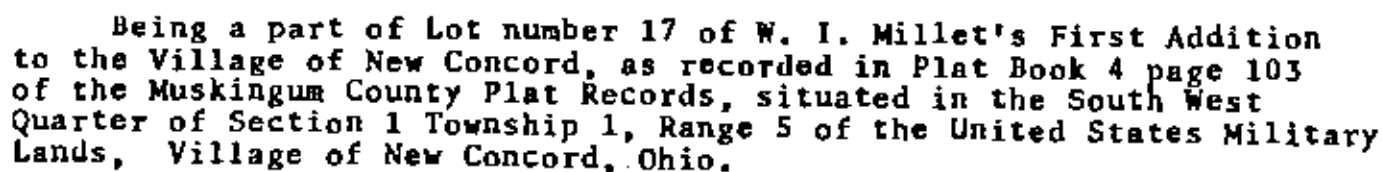

W. J. BILLENBACH
REG. SURVEYOR #5718



B Spurbir

W. J. BIEDENBACH & ASSOC. Surveying & Mapping 3120 Lee Ln. Zanesville, Ohio 43701 (614) 453-4850	
Drawn by: AB	Date: 4-19-84
Scale: 1" = 50'	Checked by: DD
Job No. 1551-4-B4	G. SUGG