

Bearings are based on the Ohio State Plane Coordinate System, South Zone, NAD83 as per GPS observations made on January 18, 2012.

This description is written based on an actual field survey performed by Linn Engineering, Inc.

**OFFICE COPY**  
**NOT RECORDABLE**

Timothy H. Linn, Registered Professional Surveyor

1/22/13  
Date

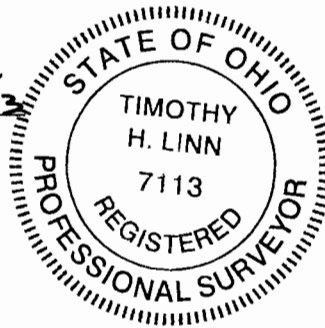

All of: 66-27-06-25-000 (0.42 ac.)  
Part of: 66-27-06-26-000 (0.22 ac.)  
Part of: 66-27-06-29-001 (0.05 ac.)  
Total acreage: (0.69 ac.)

SECTION  
1/22/13