

66-28-02-11-000



**Linn Engineering, Inc.**

*Civil Engineering Consultants*

740-452-7434 • 1-800-991-7434

534 Market Street • P.O. Box 2086 • Zanesville, Ohio 43702-2086

**NEW CONCORD UNITED METHODIST CHURCH**

**OFFICIAL RECORD 1616-259**

**All of 0.098 acres**

Situated in the Village of New Concord, Muskingum County, Ohio, bounded and described as follows:

Being a part of the Southeast Quarter of Section 1, Township 1, Range 5, also all of the lands now owned by New Concord United Methodist Church as recorded in Official Record 1616-259, and more particularly described as follows:

Beginning for reference at an iron pin found on the northwest corner of Lot 60 of College Addition as the same is designated and delineated in Muskingum County Deed Book U, Page 655;

thence crossing a 16.5' wide alley, North 55 degrees 17 minutes 36 seconds East 35.56 feet to an iron pin found on the north line of said 16.5' wide alley and the principal place of beginning;

thence along the north line of said alley South 84 degrees 42 minutes 33 seconds West 64.00 feet to an iron pin found on the southeast corner of lands now by Muskingum College (DR 561-393);

thence along the east line of said Muskingum College (DR 561-393) North 05 degrees 24 minutes 37 seconds West 66.36 feet to an iron pin found on the southwest corner of lands now owned by Muskingum College (DR 1005-11);

thence along the south line of said Muskingum College (DR 1005-11) North 84 degrees 42 minutes 18 seconds East 65.36 feet to an iron pin found on the southeast corner of said Muskingum College (DR 1005-11) and the west line of lands now owned by Muskingum College (DR 204-5);

thence along the west line of said Muskingum College (DR 204-5) South 04 degrees 13 minutes 54 seconds East 66.38 feet to the principal place of beginning; containing 0.098 acres, more or less. subject to all legal road right of ways and applicable easements, written or implied.

Bearings are based on the Ohio State Plane Coordinate System, South Zone, NAD83 as per GPS observations made on April 14, 2015.

This description is written based on an actual field survey performed by Linn Engineering, Inc.

**OFFICE COPY**  
**NOT RECORDABLE**  
Timothy H. Linn, Reg. No. 7113

7/20/16  
Date

All of: 66-28-02-11-000 (0.098 ac.)

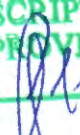
**DESCRIPTION**  
**APPROVED**  
By:  7/21/2016

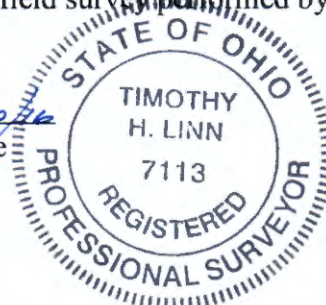



DESCRIPTION  
APPROVED

By:

*[Signature]* 1/11/2016MUSKINGUM COLLEGE  
DR 166-450MUSKINGUM COLLEGE  
DR 1005-11MUSKINGUM COLLEGE  
DR 204-5  
66-28-02-13-000

NORTH LIBERTY STREET 40' WIDE

MUSKINGUM COLLEGE  
DR 204-5  
66-28-02-13-000NEW CONCORD UNITED  
METHODIST CHURCH  
OR 1616-259  
±0.098 ac.  
66-28-02-11-000

P.P.O.B.

ALLEY

16.5' R/W

LOT 54

LOT 56

TRUSTEES OF NEW  
CONCORD METHODIST  
CHURCH  
DR 502-651

ALLEY 16.5' R/W

LOT 58

TRUSTEES OF NEW  
CONCORD METHODIST  
CHURCH  
DR 502-651

LOT 60

P.O.B.: IRON PIN  
FOUND ON THE  
NORTHWEST CORNER  
OF LOT 60 IN  
COLLEGE ADDITION,  
DR "U" - 655.MUSKINGUM COLLEGE  
OR 2121-300MUSKINGUM COLLEGE  
OR 1761-892COLLEGE ADDITION  
DR "U" - 655**LEGEND**

● IRON PIN FOUND

P.P.O.B. PRINCIPAL PLACE OF BEGINNING

**SITUATED IN**SOUTHEAST QUARTER OF  
SECTION 1, TOWN OF  
NEW CONCORD, UNION  
TOWNSHIP, T-1, R-5,  
MUSKINGUM COUNTY,  
OHIO.**BASIS OF BEARING**BEARINGS ARE BASED ON THE  
OHIO STATE PLANE COORDINATE  
SYSTEM, NAD83, SOUTH ZONE,  
GRID SOUTH, AS PER GPS  
OBSERVATIONS MADE 4/14/15.**REFERENCES**DR 204-5  
DR 1005-11  
OR 1616-259  
OR 2121-300  
DR 502-651  
DR 561-393  
DR 166-450  
DR "U" - 655**PARCEL NO.**

ALL OF: 66-28-02-11-000 (±0.098 AC.)

OFFICE COPY  
NOT RECORDABLETimothy H. Linn, P.S.  
Reg. Surveyor No. 7113

Date 1/20/16

Project No.: MUSK-1520

Linn Engineering, Inc.  
Civil Engineering Consultants  
P.O. Box 2086 Zanesville, Ohio 43702-2086

740-452-7434

