

70-09-01-01-000

Re-Survey of Kevin and Linda McKenna Lands

Situated in the State of Ohio, County of Muskingum, Township of Washington, Quarter Township Four, and being part of Lot 21, Township 2, Range 7, United States Military Lands, and being all the lands presently owned by Kevin H. McKenna, and Linda S. Madden, as per Deed Record 836, Page 343, and being more particularly described as follows:

Beginning for reference at the Southeast Corner of Lot 21;

Thence along the east line of said Lot, North 00 degrees 20 minutes 20 seconds West, 1650.00 feet, (by deed), to a point on the south line of lands presently owned by Violet Louise and James E. Madden Jr., (DR 438-235);

Thence along the south line of said Madden lands, North 85 degrees 20 minutes 20 seconds West, 316.65 feet, (by deed), to a point in the centerline of State Route 93, and the principal place of beginning;

Thence along the centerline of said state route, the following two courses:

- 1.) South 23 degrees 24 minutes 42 seconds East, 154.33 feet to a point;
- 2.) South 24 degrees 51 minutes 08 seconds East, 72.28 feet to a point on the northeast corner of lands presently owned by Jarrod D. and Melissa M. Boyce, (OR 2182-924);

Thence along the south line of said Boyce lands, North 85 degrees 15 minutes 36 seconds West, 658.82 feet to an axle found on the southeast corner of lands presently owned by Andrew L. and Paula J. Curry, (DR 781-182), passing an axle found at 34.50 feet;

Thence along the east line of said Curry lands, North 04 degrees 40 minutes 37 seconds East, 198.16 feet to an iron pipe found on the south line of said Madden lands;

Thence along the south line of said Madden lands, South 85 degrees 20 minutes 20 seconds East, (passing an axle found at 514.54 feet), 550.54 feet to the principal place of beginning, containing 2.75 acres more or less;

Subject to all legal recorded easements and right of ways.

Iron pins set are 5/8 inch rebars, 30 inches long, with plastic identification caps.

Bearings are based on the Ohio State Plane Coordinate System, NAD 83, South Zone, Grid South, as per GPS observations.

This description is written based on a field survey completed June 27, 2011 by Jack D. Newcome, Reg. No. 7321.

**OFFICE COPY**  
**NOT RECORDABLE**

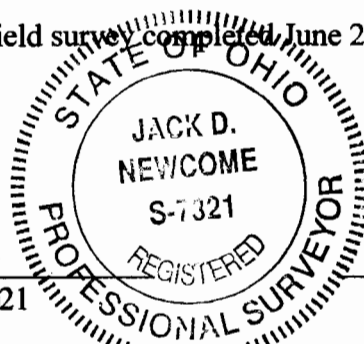

1-3-14  
Date

Parcel No: All of: 70-09-01-01-000 +-2.75 Acres, (+- 0.16 Acres in St. Rte. 93 R/W)

DESCRIPTION  
APPROVED  
*[Signature]* 11/7/2014

70-0901-01-000 A

**SITUATED IN:**

State of Ohio, County of Muskingum, Township of Washington, Quarter Township 4, and being part of Lot 21, Township 2, Range 7, United States Military Lands.

**BASIS OF BEARINGS**

Bearings are based on the Ohio State Plane Coordinate System, NAD 83, South Zone, Grid North, as per GPS observations.

**REFERENCES**

DR 636-343  
OR 2182-924

Southeast  
Corner of  
Lot 21

**DESCRIPTION**

APPROVED

By

*[Signature]* 1/7/14

**LEGEND**

- △ Railroad Spike Set
- Iron Pin Found
- ⊞ Stone Found
- Axle Found
- Iron Pipe Found
- ▲ Railroad Spike Found
- Iron Pin Set, 5/8" rebar
- ⊞ Monument Found

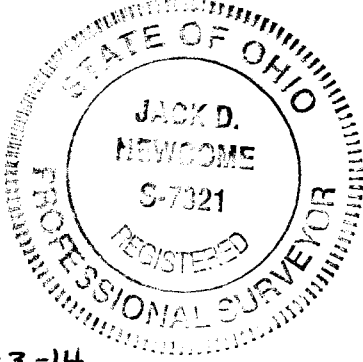

**OFFICE COPY**  
**NOT RECORDABLE**

Reg. Surveyor No. 7321

Newcome Surveying Company  
6515 Ballard Road  
Nashport, Ohio  
740-462-5796

Violet Louise and James E. Madden Jr.  
DR 438-235

**Kevin H. McKenna and  
Linda S. Madden**  
DR 836-343  
+- 2.75 Acres

Andrew L. and  
Paula J. Curry  
DR 781-182

Gale S. and  
Barbara J.  
Brewer  
DR 862-185

Jarrod D. and  
Melissa M. Boyce  
OR 2182-924

**PARCEL NO.**

All of: 70-09-01-01-000 +- 2.75 Acres  
(+- 0.16 Acres in St. Rte. 93 R\W)

