

70-15-02-15-001

Biedenbach Engineering, Inc.

3975 East Pike
Zanesville, OH 43701

Civil Engineering and Land Surveying

Telephone (740) 453-4830
Fax (740) 450-1000
E-mail biedenbach@ee.net

E. J. SHEETS

VOLUME 1139, PAGE 703

AUDITORS PARCEL NUMBER 70-70-15-02-15-000 (PART) - 1.875 MORE OR LESS ACRES

AUDITORS PARCEL NUMBER 70-70-15-02-20-000 (PART) - 0.567 MORE OR LESS ACRES

BEING A PART OF THE TRACT CONVEYED TO E. J. SHEETS BY DEED RECORDED IN VOLUME 1139, PAGE 703 OF THE MUSKINGUM COUNTY DEED RECORDS, SITUATED IN THE SOUTH HALF OF SECTION 2, TOWNSHIP 1, RANGE 7, OF THE UNITED STATES MILITARY LANDS, WASHINGTON TOWNSHIP, MUSKINGUM COUNTY, OHIO AND BEING FURTHER DESCRIBED AS FOLLOWS:

COMMENCING AT THE NORTHWEST CORNER OF THE SOUTHEAST QUARTER OF SECTION 2;

THENCE NORTH 87 DEGREES 40 MINUTES 24 SECONDS WEST 203.96 FEET TO A POINT ON THE WEST LINE OF THE 0.281 MORE OR LESS ACRE TRACT CONVEYED TO M. AND P. HAMBEL BY DEED RECORDED IN VOLUME 1017, PAGE 17 OF THE MUSKINGUM COUNTY DEED RECORDS, SAID POINT BEING SOUTH 16 DEGREES 04 MINUTES 49 SECONDS WEST 3.55 FEET FROM AN EXISTING 1/4 INCH PIPE AT THE SOUTHWEST CORNER OF A 1.19 ACRE TRACT CONVEYED TO F. AND J. DRISKEL BY DEED RECORDED IN VOLUME 723, PAGE 238 OF THE SAID COUNTY RECORDS, SAID POINT ALSO BEING THE PLACE OF BEGINNING OF THE TRACT HEREIN INTENDED TO BE DESCRIBED;

THENCE WITH THE WEST AND SOUTH LINES OF THE ABOVE SAID HAMBEL TRACT THE NEXT THREE COURSES AND DISTANCES:

- 1) SOUTH 16 DEGREES 04 MINUTES 49 SECONDS WEST 11.16 FEET TO AN EXISTING IRON PIN (5/8 INCH REBAR);
- 2) SOUTH 07 DEGREES 08 MINUTES 38 SECONDS EAST 229.17 FEET TO AN EXISTING IRON PIN (5/8 INCH REBAR);
- 3) NORTH 84 DEGREES 41 MINUTES 29 SECONDS EAST 247.52 FEET TO A POINT IN THE CENTER OF COUNTY ROAD 110 (CHURCH HILL ROAD), PASSING AN EXISTING IRON PIN (5/8 INCH REBAR) AT 220.02 FEET;

THENCE WITH THE CENTER OF THE SAID ROAD THE NEXT THREE COURSES AND DISTANCES:

- 1) SOUTH 14 DEGREES 09 MINUTES 17 SECONDS EAST 70.49 FEET TO A POINT;
- 2) SOUTH 18 DEGREES 10 MINUTES 39 SECONDS EAST 97.65 FEET TO A POINT;
- 3) SOUTH 19 DEGREES 53 MINUTES 30 SECONDS EAST 59.23 FEET TO A POINT;

THENCE LEAVING THE SAID ROAD, SOUTH 88 DEGREES 34 MINUTES 10 SECONDS WEST 414.52 FEET TO AN IRON PIN SET, PASSING AN IRON PIN SET AT 21.11 FEET;

THENCE NORTH 04 DEGREES 00 MINUTES 00 SECONDS WEST 447.78 FEET TO AN IRON PIN SET ON THE SOUTH LINE OF A TRACT CONVEYED TO R. GREEN (DEED VOLUME 1078, PAGE 132);

THENCE WITH THE SOUTH LINE OF SAID GREEN TRACT, SOUTH 87 DEGREES 40 MINUTES 24 SECONDS EAST 106.00 FEET TO THE PLACE OF BEGINNING.

CONTAINING 2.442 MORE OR LESS ACRES TOTAL, OF WHICH 1.875 MORE OR LESS ACRES IS IN THE SOUTHWEST QUARTER AND 0.567 MORE OR LESS ACRES ARE IN THE SOUTHEAST QUARTER, SUBJECT TO ALL LEGAL ROAD RIGHT-OF-WAYS OF COUNTY ROAD 110 (CHURCH HILL ROAD) AND ALL OTHER APPLICABLE EASEMENTS.

ALL IRON PINS SET ARE 5/8 INCH X 30 INCH REBAR WITH PLASTIC IDENTIFICATION CAPS (BIEDENBACH PS5718-PS6923).

THE BEARINGS ARE BASED ON THE PREVIOUS SURVEY OF THE SOUTH LINE OF SECTION 2 DATED 2/17/98 BY LINN ENGINEERING, INC.

I HEREBY CERTIFY TO THE BEST OF MY KNOWLEDGE AND BELIEF THE SURVEY AND DESCRIPTION TO BE CORRECT AS PREPARED BY ME, THIS 4TH DAY OF JANUARY 2002.

MICHAEL D. NICK
REGISTERED SURVEYOR

DESCRIPTION APPROVED
FOR AUDITOR'S TRANSFER
BY A.L. Swadlow
1-9-2002 kb

SURVEY FOR MARK HAMBEL

AUDITORS PARCEL NUMBERS

70-70-15-02-15-000 (PART) - 1.875 ± ACRES

70-70-15-02-20-000 (PART) - 0.567 ± ACRES

BEING A PART OF THE TRACT CONVEYED TO E. J. SHEETS (DEED VOLUME 1139, PAGE 703), SITUATED IN THE SOUTH HALF OF SECTION 2, TOWNSHIP 1, RANGE 7, OF THE UNITED STATES MILITARY LANDS, WASHINGTON TOWNSHIP, MUSKINGUM COUNTY, OHIO.

BEARINGS ARE BASED ON THE PREVIOUS SURVEY OF THE SOUTH LINE OF SECTION 2 DATED 2/17/98 BY LNN ENGINEERING, INC.

RESEARCH:

VOL. 524, PG. 214
VOL. 1078, PG. 132
VOL. 1085, PG. 510
VOL. 1088, PG. 43
VOL. 723, PG. 238
VOL. 1129, PG. 515
VOL. 1040, PG. 81
MUSKINGUM CO. TAX MAP

LEGEND

- EXISTING IRON PIN
- ⊙ IRON PIN SET (5/8" REBAR W/CAP)
- ANGLE POINTS
- EXISTING STONE

SCALE 1"=100'

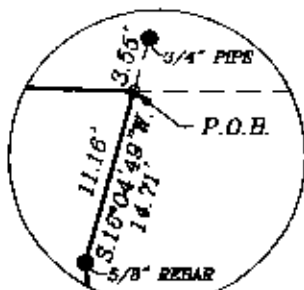

IRON PIN DETAIL
NOT TO SCALE

R. GREEN
VOL. 1078, PG. 132

F. & J. DRISKEL
VOL. 723 PG. 238

NORTHWEST CORNER OF THE
SOUTHEAST QUARTER OF
SECTION 2

S. 87°40'24"E. 106.00'
N. 87°40'24"W. 203.98'

SEE DETAIL

M. & P. HAMBEL
VOL. 1017, PG. 17
VOL. 1075, PG. 327

E. J. SHEETS
VOL. 1139, PG. 703
2.442 ± ACRES (TOTAL)

LINE DATA

No.	BEARING	DISTANCE
1	S. 14°09'17"E.	70.40'
2	S. 16°10'39"E.	97.85'
3	S. 19°53'30"E.	59.23'

N. 04°00'00"W. 447.78'

1.875 ± ACRES

5/8" REBAR

N. 84°41'29"E. 247.52'
220.02' 5/8" REBAR
27.50'

CHARLES JONES
VOL. 1088, PG. 43

MID SECTION LINE

0.567 ± ACRES

393.41'
S. 88°34'10"W. 414.52'

21.11'

E. COUNTY ROAD 110
(CHURCH HILL ROAD)

E. J. SHEETS
VOL. 1139, PG. 703

DESCRIPTION APPROVED
FOR AUDITOR'S TRANSFER

BY *ALL ID*
1-9-2002

BIEDENBACH ENGINEERING, INC.
ZANESVILLE, OHIO
(740) 453-850

DRAWN BY: AJS	DATE: 01-04-02
SCALE: 1"=100'	CHECKED BY: MDN
JOB NO: 4776	DRAWING NO: D:\4776\4776

I HEREDY CERTIFY TO THE BEST OF MY
KNOWLEDGE AND BELIEF THE ABOVE PLAT AND
SURVEY TO BE CORRECT AS PREPARED BY ME,
THIS 4th DAY OF JANUARY, 2002.

MICHAEL D. NICHOLS
REGISTERED SURVEYOR

OFFICE COPY
NOT RECORDABLE