

70-38-01-16-000



Betty N. Murphy
DR 615-96
+/-0.333 Ac.

Being a part of Quarter Township 3, Township 1, Range 7, Washington Township, Muskingum County, also being a part of Lot 2 in Underwoods Subdivision, Deed Book "E", Page 62 and being all of the lands now owned by Betty N. Murphy as recorded in Deed Record 615-96 of the Muskingum County Recorder more fully described as follows.

Beginning for reference at an iron pin found on the northwest corner of Lot 2 in Underwoods Subdivision, Deed Book "E", Page 62, also being the common corner of the lands now owned by Robert E. Wagner, TOD @ 2 (OR 2385-697) and Jamie A. Krouskoupf (OR 2487-741), thence South 86 degrees 45 minutes 01 seconds East, 2184.95 feet to an pipe found;

thence with the east line of the lands now owned by Trudy D. Fesler (OR 2196-681), South 01 degrees 55 minutes 20 seconds West, 907.29 feet to a point in the center of Adamsville Road, passing a pipe found at 882.13 feet;

thence with the center of said Adamsville Road, South 84 degrees 12 minutes 34 seconds East, 35.73 feet to the place of beginning for the 0.333 acre tract of land being described;

thence leaving the center of said Adamsville Road and with the common line of said Jamie A. Krouskoupf and the lands now owned by Betty N. Murphy the following two (2) courses:

1. North 02 degrees 12 minutes 34 seconds East, 143.45 feet to an iron pin set, passing an iron pin set at 25.00 feet;
2. South 83 degrees 47 minutes 26 seconds East, 100.00 feet to an iron pin set on the west line of the lands now owned by Claudia Jean Batteiger (OR 2395-734);

thence with said Batteiger's west line, South 02 degrees 12 minutes 34 seconds West, 150.35 feet to a point in the center of said Adamsville Road, passing a pipe found at 124.65 feet;

thence with the center of said Adamsville Road the following three (3) courses:

1. North 74 degrees 44 minutes 56 seconds West, 22.99 feet to a point;
2. North 80 degrees 05 minutes 12 seconds West, 51.51 feet to a point;
3. North 83 degrees 54 minutes 50 seconds West, 26.38 feet to the point of beginning, containing 0.333 acres more or less, subject to all legal highways and easements of record.

All bearings described herein are based on the Ohio State Plane Grid Coordinates, NAD83, Ohio South per GPS Observation.

All iron pins set are 5/8 inch by 30 inch steel rebar with plastic identification caps marked MCPEEK PS8517.

The above described 0.333 acre parcel is based on a field survey made by McPeek Land Surveying on September 3rd, 2013.

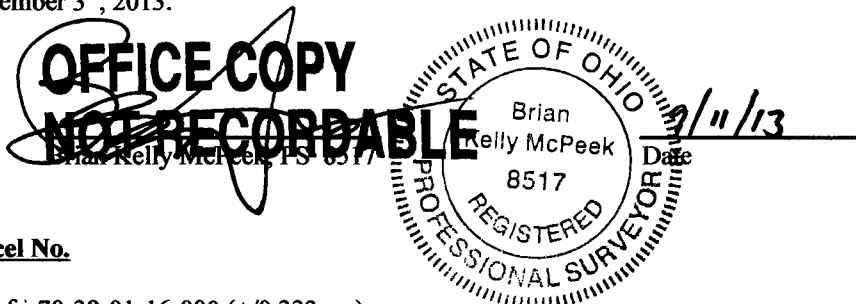

Parcel No.

All of : 70-38-01-16-000 (+/-0.333 ac.)

DESCRIPTION
APPROVED

By:  9/13/2013

70-38-01-16-000 A

RE-SURVEY

POB- NW Corner of Lot 2
Underwoods Subdivision
Deed Bk. "E", Page 62

Robert E. Wagner, TOD @ 2
OR 2385-697

Jamie A. Krouskoupf
OR 2487-741

N 87°27'08" W
139.97'

N 86°08'17" W

Jamie A. Krouskoupf
OR 2487-741

Trudy D. Fesler
OR 2196-681

Claudia Jean Batteliger
OR 2395-734

SITUATED IN

The State of Ohio, County of Muskingum
Township of Washington, and being a part
Lot 2 of Underwoods Subdivision, BK "E", Pg. 62.

BASIS OF BEARING

Bearings are based on State Plane Ground
Coordinates, NAD83, Ohio South,
per GPS Observation.

REFERENCES

* As Noted on Plat
www.muskingumcountyauditor.org
www.mceo.org
<http://recorder.muskingumcounty.org>
Previous Surveys by: Adcock, Bowman,
Binkley, Linn and Filney

LEGEND

- Iron Pin Set, 5/8" rebar (MCPEEK 8517)
- Iron Pin Found
- Z— Property Hook
- Iron Pipe Found

| LINE | BEARING | DISTANCE |
|------|---------------|----------|
| L1 | N 02°12'34" E | 143.45' |
| L2 | S 83°47'26" E | 100.00' |
| L3 | S 02°12'34" W | 150.35' |
| L4 | N 74°44'56" W | 22.99' |
| L5 | N 80°05'12" W | 51.51' |
| L6 | N 83°54'50" W | 26.38' |

PARCEL NO.

All of: 70-38-01-16-000(±0.333 ac.)

DESCRIPTION

APPROVED

By: *[Signature]* 2/12/2013

GRAPHIC SCALE



(IN FEET)

1 inch = 200 ft.

CL Adamsville Rd.

S 84°12'34" E
35.73'

Betty N. Murphy

OR 615-96

±0.333 Ac.

Parcel No.: 70-38-01-16-000

OFFICE COPY
~~NOT RECORDABLE~~
2/9/13
Reg. Surveyor No. 8517

MCPEEK
LAND
SURVEYING
mcpeeklandsurveying.com
423 Smithfield Ave., Zanesville, Ohio 43701
740.704.6073

