

Survey for KJF Enterprises, LLC.

Being a part of land located in the State of Ohio, County of Muskingum, Washington Township, part of quarter township 3, Township 1 North, Range 7 West, United States Military Lands. Being part of the lands conveyed to KJF Enterprises, LLC. in Deed Record 1759, page 776 Tract 1, Parcel 2, bounded and described as follows:

Commencing at an iron pin found at the northwest corner of Lot 7 of McBride's Addition (Replat Book 1, page 255);

thence along the south line of a vacated 16' wide alley and along the north line of Lot 7 North 79 degrees 03 minutes 33 seconds East 16.39 feet to an iron pin found;

thence continuing along the south line of a vacated 16' wide alley and along the north line of Lot 7 North 79 degrees 03 minutes 33 seconds East 109.29 feet to a point on the east line of a vacated 8' wide alley, the **place of beginning** for this parcel;

thence along the east line of said vacated alley North 12 degrees 26 minutes 27 seconds West 19.59 feet to an iron pin set;

thence leaving the east line of said vacated alley and through KJF Enterprises, LLC. (DR 1759-776, tr.1, prcl.2) the following three courses:

1. North 75 degrees 21 minutes 16 seconds East 235.17 feet to an iron pin set;
2. North 51 degrees 03 minutes 54 seconds East 69.69 feet to an iron pin set;
3. North 12 degrees 10 minutes 11 seconds East 57.34 feet to an iron pin set on a line of The County of Muskingum, Ohio (DR 1135-467, tr.1);

thence along The County of Muskingum, Ohio (DR 1135-467, tr.1) South 11 degrees 41 minutes 49 seconds East 120.00 feet to an iron pin set;

thence along another line of The County of Muskingum, Ohio (DR 1135-467, tr.1) South 75 degrees 21 minutes 16 seconds West 319.93 feet to an iron pin set on the east line of a vacated 8' wide alley;

thence along the east line of said vacated alley North 12 degrees 26 minutes 27 seconds West 20.44 feet to the place of beginning containing 0.34 acres, more or less.

Part of Parcel #:

71-70-55-01-08-000 (\pm 0.34 acres)

This legal description was written by Denis P. Swierz based on a field survey completed March 2013 by Muskingum County Engineers' Office. The bearings in this description are based on NAD 83, Ohio South Zone, State Plane Coordinates as per GPS observations from Muskingum County Engineer monument – GPS 22.

Subject to all easements, right of ways, restrictions, reservations, etc.. of record and those that may be implied.

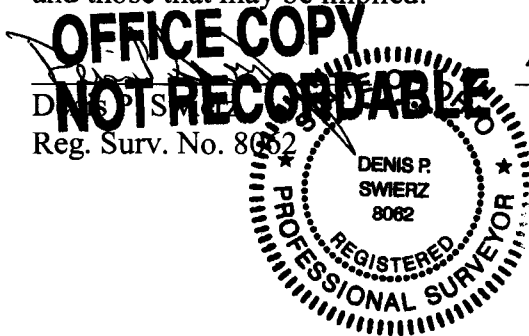

4/08/13
Date

DESCRIPTION
APPROVED

By: *[Signature]* 4/11/2013

SURVEY FOR KJF ENTERPRISES, LLC

STATE OF OHIO, MUSKINGUM COUNTY, WASHINGTON TOWNSHIP,
PART OF QUARTER TOWNSHIP 3, TOWNSHIP 1 NORTH, RANGE 7
WEST, UNITED STATES MILITARY LANDS
PART OF: 71-70-55-01-08-000 ±0.34 ACRES

DESCRIPTION
APPROVED

By: *[Signature]* 4/11/2013

THE COUNTY OF MUSKINGUM, OHIO
DR 1135-467 (TRACT #1)

KJF ENTERPRISES, LLC
DR 1759-776
(TRACT 1, PARCEL 2)

KJF ENTERPRISES, LLC.
±0.34 ACRES
DR 1759-776, TR.1, PRCL.2

PUBLIC STREET
(50' WIDE)

NORTHWEST CORNER OF
LOT 7 OF McBRIDES
ADDITION, (REPLAT
BOOK 1, PAGE 255)

KJF ENTERPRISES, LLC
DR 1759-776
(TRACT 1, PARCEL 1)
LOT 5

L1 VACATED ALLEY (16' WIDE)
N 79°03'33" E
109.29 FT

LOT 7
THE COUNTY OF
MUSKINGUM, OHIO
DR 1135-467 (TRACT #4)

VACATED ALLEY (8' WIDE)

P.O.B.

VACATED ALLEY (8' WIDE)

N 75°21'16" E
235.17 FT
S 75°21'16" W
319.93 FT

THE COUNTY OF MUSKINGUM, OHIO
DR 1135-467 (TRACT #1)

S 11°41'49" E
120.00 FT
E 127

NUMBER	DIRECTION	DISTANCE
L1	N 79°03'33" E	16.39 FT
L2	N 12°26'27" W	19.59 FT
L3	N 12°10'11" E	57.34 FT
L4	N 12°26'27" W	20.44 FT

BASIS OF BEARING:

BEARINGS ARE BASED ON NAD 83, OHIO
SOUTH ZONE, STATE PLANE COORDINATES
AS PER GPS OBSERVATIONS FROM MUSKINGUM
COUNTY ENGINEER GPS MONUMENT - GPS 22.

PERTINENT DOCUMENTS AND SURVEYS USED:

1. DEED REFERENCES SHOWN
2. TAX MAPS
3. SURVEY RECORDS FOUND IN THE
MUSKINGUM COUNTY ENGINEERS OFFICE,
ZANESVILLE, OHIO.

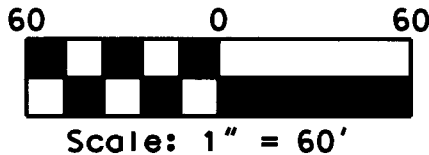

LEGEND

- IRON PIN SET 5/8" X 30" W/CAP
MARKED "MUSK CTY"
"SWIERZ 8062"
- IRON PIN FOUND
- POINT

MUSKINGUM COUNTY ENGINEERS OFFICE

155 REHL ROAD
ZANESVILLE, OHIO 43701
(740) 454-0155

I HEREBY CERTIFY THIS PLAT
TO BE CORRECT AS SURVEYED
MARCH 2013

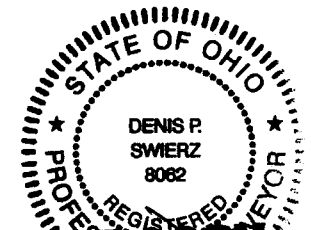

OFFICE COPY
NOT RECORDED

DATE 4/08/13