

70-58-01-22-000

Re-Survey of Muskingum County Land Reutilization Corporation lands

Situated in the State of Ohio, County of Muskingum, Township of Washington, and being part of Quarter Township 3, Township 1, Range 7, United States Military Lands, and being all the lands presently owned by the Muskingum County Land Reutilization Corporation, as per Official Record 2527, Page 323, and being more particularly described as follows:

Beginning for reference at the Northeast corner of Lot 53, of The William Bateman Addition, Pl. Bk. 5, Pg. 74, being on the south right of way of U. S. Route 40;

Thence along the south right of way of said route, (by deed), North 76 degrees 05 minutes 40 seconds East, 85.15 feet;

Thence leaving said right of way, (by deed), North 13 degrees 54 minutes 20 seconds West, 40.00 feet to the centerline of said route;

Thence along the centerline of said route, (by deed), North 75 degrees 58 minutes 02 seconds East, 79.54 feet to a point on the southeast corner of lands presently owned by Joseph E. and Connie J. Schaumleffel, (DR 767-307), and the principal place of beginning;

Thence along the east line of said Schaumleffel lands, North 02 degrees 21 minutes 38 seconds West, 269.40 feet to an iron pin set on the south line of lands presently owned by Tymac LLC, (OR 2484-241), passing an axle found at 41.60 feet;

Thence along the south line of said Tymac lands, North 87 degrees 09 minutes 36 seconds East, 103.36 feet to an iron pin found disturbed and re-set on the northwest corner of lands presently owned by Timothy J. and Margaret M. Jordan, (DR 1099-593);

Thence along the east line of said Jordan lands, South 04 degrees 45 minutes 16 seconds East, 247.48 feet to the centerline of U. S. Route 40, passing an iron pin found at 205.80 feet;

Thence along the centerline of said route, South 76 degrees 12 minutes 01 seconds West, 116.00 feet, to the principal place of beginning, containing 0.65 acres, more or less

Subject to all legal recorded easements and right of ways.

Iron pins set are 5/8 inch rear, 30 inches long, with plastic identification caps.

Bearings are based on the Ohio State Plane Coordinate System, NAD 83, South Zone, Grid North, as per GPS observations.

This description is written based on a field survey completed April 26, 2014, by Jack D. Newcome, Reg. No. 7321.

**OFFICE COPY  
NOT RECORDABLE**

*Jack D. Newcome*  
Jack D. Newcome, Reg. No. 7321

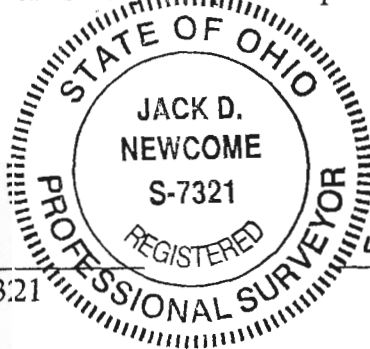

4-28-14  
Date

Parcel No. All of: 70-58-01-22-000 +- 0.65 Acres

DESCRIPTION  
APPROVED

By: *[Signature]* 4/28/14

70-58-01-22-000 A

Tymac LLC  
OR 2484-241

axle found  
0.60' offline

N 87°09'36"E 103.36'

Angle iron in  
Concrete

7.26'

Muskingum County  
Land Reutilization  
Corporation  
OR 2527-323  
+- 0.65 Acres

Timothy J. and  
Margaret M. Jordan  
DR 1099-593

Joseph E. and  
Connie J.  
Schaumleffel  
DR 767-307

N 02°21'38"W 269.40'

S 04°45'16"E 247.48'

41.68'

41.60'

79.54'

N 75°58'02"E  
(by deed)

N 13°54'20"W  
40.00'  
(by deed)

N 76°05'40"E 85.15'  
(by deed)

U. S. Route 40

### SITUATED IN:

State of Ohio, County of Muskingum, Township of  
Washington, Quarter Township 3, Township 1,  
Range 7, United States Military Lands.

### BASIS OF BEARINGS

Bearings are based on the Ohio State Plane  
Coordinate System. NAD 83, South Zone, Grid  
North, as per GPS observations.

### REFERENCES

DR 786-113  
DR 1099-593  
DR 767-307  
OR 2484-241

### PARCEL NO.

All of: 70-58-01-22-000 +- 0.65 Acres

### LEGEND

- △ Railroad Spike Set
- Iron Pin Found
- ⊞ Stone Found
- Axle Found
- Iron Pipe Found
- ▲ Railroad Spike Found
- ⊙ Iron Pin Set, 5/8" rebar
- ⊞ Monument Found

DESCRIPTION  
APPROVED

By:

Northeast corner of Lot 53,  
of The William Bateman  
Addition, Pl. Bk. 5, Pg. 74

85' 50' 100'  
Ohio Scale in Feet 1"=50'

OFFICE COPY  
NOT RECORDABLE  
Jack D. Newcome  
Reg. Surveyor No. 7321  
Date 4-28-14

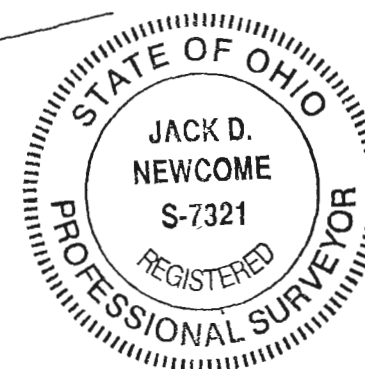

Newcome Surveying Company  
6515 Ballard Road  
Nashport, Ohio  
740-452-5796