

70-60-018-000



Linn Engineering, Inc.

Civil Engineering Consultants

740-452-7434 • 1-800-991-7434

534 Market Street • P.O. Box 2086 • Zanesville, Ohio 43702-2086

Gerald E. and Pearl Fesler

DR 577-821

± 13.62 Acres

Situated in the State of Ohio, County of Muskingum, Township of Washington, bounded and described as follows:

Being a part of the Fourth Quarter of Township 1, Range 7, United States Military Lands and being all of the lands now owned by Gerald E. and Pearl Fesler as recorded in Muskingum County Deed Record 577-821, and more particularly described as follows:

Beginning for reference at a stone found at the northwest corner of the Southeast Quarter of the Northwest Quarter of the Fourth Quarter of Township 1;

thence along the south line of lands now owned by Teresa M. Hildebrand (OR 2205-905), South 86 degrees 53 minutes 44 seconds East 582.52 feet to an iron pin set and the principal place of beginning;

thence continuing along said Hildebrand's south line the following three courses:

- 1) North 02 degrees 36 minutes 39 seconds East 529.44 feet to a stone found;
- 2) South 86 degrees 53 minutes 44 seconds East 1120.46 feet to an iron pin set;
- 3) South 02 degrees 36 minutes 39 seconds West 529.44 feet to an axle found on the northeast corner of lands now owned by Gerald E. and Pearl Fesler (DR 1064-531);

thence along said Feslers' north line, North 86 degrees 53 minutes 44 seconds West 155.65 feet to an axle found on the northeast corner of lands now owned by J. Todd and Julie L. Sands (OR 1985-657);

thence along the north line of said Sands' lands, North 86 degrees 53 minutes 44 seconds West 964.81 feet to the principal place of beginning;

containing 13.62 acres, more or less, subject to all legal road right of ways and applicable easements, written or implied.

There is appended to the above described tract an AUGMENTED EASEMENT for the purpose of ingress and egress, and being more particularly described as follows:

Being a 25 foot wide strip to the west of the east line of lands now owned by owned by Gerald E. and Pearl Fesler (DR 1064-531), being more particularly described as follows;

70-60-01-18-000 A

Being a part of the Fourth Quarter of Township 1, Range 7, United States Military Lands and being appended to the lands now owned by Gerald E. and Pearl Fesler as recorded in Muskingum County Deed Record 577-821, and more particularly described as follows:

Beginning for reference at a stone found at the northwest corner of the Southeast Quarter of the Northwest Quarter of the Fourth Quarter of Township 1;

thence South 86 degrees 53 minutes 44 seconds East 1702.98 feet to an axle found on the northeast corner of lands now owned by Gerald E. and Pearl Fesler (DR 1064-531); and the principal place of beginning;

thence along said Fesler's east line the following two courses:

- 1) South 01 degrees 20 minutes 37 seconds East 70.9 feet to an axle found;
- 2) South 26 degrees 01 minutes 02 seconds West 359.0 feet to an iron pin found on the east line of land now owned by J. Todd and Julie L. Sands (OR 1985-657);

thence along the east line of said Sands' lands, North 00 degrees 03 minutes 17 seconds East 57.10 feet to a point;

thence through said Gerald E. and Pearl Fesler's lands the following two courses:

- 1) North 26 degrees 01 minutes 02 seconds East 301.6 feet to a point;
- 2) North 01 degrees 20 minutes 37 seconds West 66.7 feet to a point on the north line of said J. Todd and Julie L. Sands' lands;

thence along said Sands' north line, South 86 degrees 53 minutes 44 seconds East 25.1 feet to the principal place of beginning of said ingress and egress easement.

Iron pins set are 5/8 inch diameter by 30 inch long rebar with plastic identification caps.

Bearings are based on the Ohio State Plane Coordinate System, South Zone, NAD83 per GPS Observations made on September 9, 2014.

This description is written based on a survey completed September 12, 2014 by Timothy H. Linn, Reg. No. 7113.

OFFICE COPY
NOT RECORDABLE
Timothy H. Linn, Reg. No. 7113

9/22/14

Parcel No.

All of: 70-60-01-18-000 (\pm 13.62 ac.)

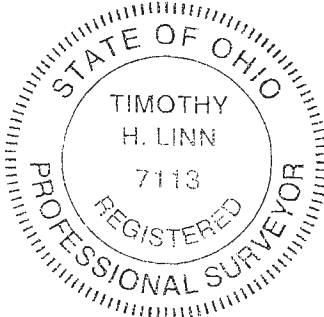

DESCRIPTION
APPROVED
By: [Signature]

9/24/2014

TERESA M. HILDEBRAND
OR 2205 PG 905
Parcel 70-60-01-17-000

TERESA M. HILDEBRAND
OR 2205 PG 905
Parcel 70-60-01-17-000

GERALD E. &
PEARL FESLER
DR 577 PG 821
13.62 ACRES
Parcel 70-60-01-18-000

TERESA M. HILDEBRAND
OR 2205 PG 905
Parcel 70-60-01-27-000

SITUATED IN:

The State of Ohio, County of Muskingum,
Township of Washington, and being part of the
4th Quarter, T-1, R-7, U.S.M.L.

PARCEL No.

All of: 70-60-01-18-000 ±13.62 ac.

BASIS OF BEARINGS

Bearings are based on the Ohio State Plane
Coordinate System, South Zone, NAD83 per GPS
observations on 09/09/14.

LEGEND

- ⊙ Iron Pin Set
- ⊙ Iron Pin Found
- ⊗ Stone Found
- Axle Found
- [PPOB] Principal Place of Beginning
- Easement

REFERENCES

DR 557-821
OR 2205-905
DR 538-612
DR 1064-531
DR 997-173
OR 1985-657

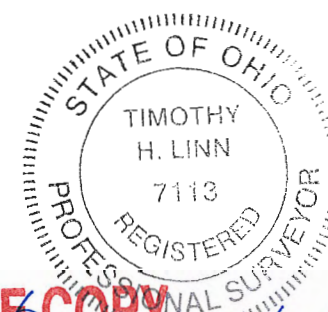

OFFICE COPY
NOT RECORDABLE
Timothy H. Linn
Registered Professional Surveyor No. 7113
Date 9/22/14

PLACE OF BEGINNING
NW corner of the SE Quarter
of the NW Quarter of the
4th Quarter, T-1, R-7, U.S.M.L.

S 86°53'44" E
582.52'

N 02°36'39" E
529.44'

[PPOB]

N 86°53'44" W

S 86°53'44" E
1120.46'

1120.46'

964.81'

GERALD E. &
PEARL FESLER
DR 1064 PG 531
Parcel 70-60-01-19-000

J. TODD &
JULIE L. SANDS
OR 1985 PG 657
Parcel 70-60-01-15-000

13' INGRESS/EGRESS
EASEMENT PER DR 1064-531

ROBERT L. &
VALERIA M. AKENS
DR 538 PG 612
Parcel 70-60-01-20-000

25' INGRESS/EGRESS
AUGMENTED EASEMENT

VALERIA M. AKENS
DB 997 PG 173
Parcel 70-60-01-20-001

DESCRIPTION

APPROVED

By:

LINE	BEARING	DISTANCE
L1	S 01°20'37" E	70.9'
L2	S 26°01'02" W	359.0'
L3	N 00°03'17" E	57.1'
L4	N 26°01'02" E	301.6'
L5	N 01°20'37" W	66.7'
L6	S 86°53'44" E	25.1'



1 inch = 200 ft.



Linn Engineering, Inc.
Civil Engineering Consultants
P.O. Box 2086 Zanesville, Ohio 43702-2086

740-452-7434