

DESCRIPTION OF SURVEY FOR WILMA BETTY GLAUB

JOB#18
55

Situated in the State of Ohio, County of Muskingum, Township of Wayne:

Being part of the Southwest Quarter of Section 2, and Southeast Quarter, of Section 3, Township 12, Range 13, of the Congress Lands East of the Scioto River, **being** the remainder of the Wilma Betty Glaub property recorded in Deed Book Volume 657, Page 130, of said county's deed records, further being all of Muskingum County **Auditor's Parcel Number 73-06-11-18-000**, and more particularly described as follows;

Commencing at an iron pin (found) at the common corner for Sections 2, 3, 8, and 9 of said Township and Range;

- TIE-1** THENCE South 87 degrees 13 minutes 50 seconds East 614.26 feet along the common line for Sections 2 and 9 to an unmarked point in the centerline of Grieves Lane (TR 291), passing an iron pipe (found) at 584.26 feet;
- TIE-2** THENCE North 37 degrees 59 minutes 35 seconds West 404.00 feet into Section 2 and along said road to an unmarked common corner for said W Glaub property and for the Jesse L Shreve and Jane A Shreve property recorded in Official Record Volume 2165, Page 314, also being the place of beginning for the property herein intended to be described;
- #1-** THENCE along a curve to the left having, a chord bearing North 58 degrees 26 minutes 55 seconds West 228.18 feet, a radius of 530.16 feet, and arc length of 229.97 feet continuing along said road to an unmarked point;
- #2-** THENCE North 70 degrees 52 minutes 30 seconds West 201.43 feet continuing along said road to an unmarked point;
- #3-** THENCE along a curve to the right having, a chord bearing North 38 degrees 41 minutes 50 seconds West 176.94 feet, a radius of 166.12 feet, and arc length of 186.59 feet continuing along said road to an unmarked point;
- #4-** THENCE North 06 degrees 31 minutes 10 seconds West 92.32 feet continuing along said road to the Southwest corner of the Russell E Glaub Jr. and Sharon K Glaub property recorded in Deed Book Volume 518, Page 23;
- #5-** THENCE North 77 degrees 26 minutes 45 seconds East 305.68 feet leaving said road and along said R & S Glaub property to an iron pin (found) on the West line of the Amanda Meredith property recorded in Official Record Volume 2185, Page 863, passing an iron pipe (found) at 17.48 feet;
- #6-** THENCE South 01 degrees 13 minutes 40 seconds West 97.55 feet along said Meredith property to an iron pipe (found);
- #7** THENCE North 85 degrees 29 minutes 15 seconds East 182.38 feet continuing along said Meredith property to an iron pipe (found);
- #8-** THENCE North 08 degrees 38 minutes 00 seconds West 246.96 feet continuing along said Meredith property to an iron pipe (found) on the South line of the Dwight W Hill and Mary I Hill property recorded in Deed Book Volume 626, Page 235;
- #9-** THENCE North 81 degrees 14 minutes 15 seconds East 206.78 feet along a common line for said W Glaub and Hill properties to an axle (found) on a line of the James D Paul and Gerald J Paul and Thomas F Paul property recorded in Official Record Volume 2256, Page 187;
- #10-** THENCE South 25 degrees 23 minutes 05 seconds East 649.03 feet along the common line for said W Glaub and Paul properties to an iron pipe (found) at a common corner for said W Glaub and Shreve properties;
- #11-** THENCE South 78 degrees 08 minutes 10 seconds West 426.90 feet along said W Glaub and Shreve properties to the place of beginning, passing an axle (found) at 406.46 feet, containing 6.82 acres in Section 2 and 0.88 acres in Section 3, for a **total of 7.70 acres**, of which 0.33 acres are within the right of way for Grieves Lane.

The bearings within this description are based on State Plane Coordinate Grid (Ohio South 1983) derived from GPS Observations. Iron pins (set) are 5/8" rebar with identification caps (C.R.Harkness P.L.S.6885).

This description was written by Charles R. Harkness Professional Land Surveyor #6885 from an actual survey completed on September 24, 2010 in accordance with Chapter 4733-37 of the Administrative Code, and is intended to be used for the legal transfer of the property described and does not intend to describe all or any easements of record, nor encroachments unless otherwise indicated.

**OFFICE COPY
NOT RECORDED**
Charles R. Harkness PLS 6885

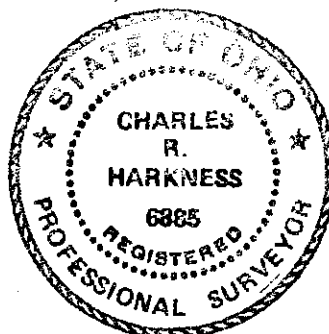

DESCRIPTION
APPROVED
By: *[Signature]* 9/30/2010

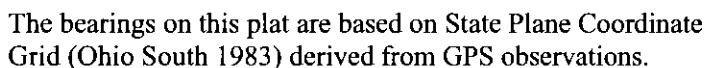

Being part of the Southwest Quarter of Section 2, and Southeast Quarter, of Section 3, Township 12, Range 13, of the Congress Lands East of the Scioto River, **being** the remainder of the Wilma A Glaub property recorded in Deed Book Volume 657, Page 130, of said county's deed records, further being all of Muskingum County **Auditor's Parcel Number 73-06-11-18-000:**

- LEGEND
- | | |
|---|--|
| ○ | PIN (SET) 5/8" REBAR CAPPED
(C R HARKNESS PLS#6885) |
| ● | PIN (FOUND) |
| △ | POINT (UNMARKED) |
| ⦿ | PIPE (FOUND) |
| ⊗ | AXLE (FOUND) |

Note #1- Section line not located by survey. Shown for graphical and Auditor's purposes only.
Note #2- Existing gravel drive is not within the 8 foot wide easement recorded in OR Vol. 2185, Page 863.
Note #3- 0.33 acres within Grieves Lane (TR 291) assumed RW Width 40 feet.

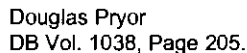

This plat was prepared by C.R. Harkness Surveying & Mapping Inc. in accordance with Chapter 4733-37 of the Administrative Code, and is intended to be used for the legal transfer to describe all or any easements of record, nor encumbrances unless otherwise indicated

By: [Signature] 9/30/2010



OFFICE COPY
NOT RECORDED

SURVEY FOR:

WILMA B GLAUB



HARKNESS SURVEYING & MAPPING, INC.
8205 OLD TOWN ROAD
ROSEVILLE, OHIO 43777
PHONE/FAX (740) 849-0122



SURVEYED: 09/24/10 DRAWN:09/24/10

JOB NUMBER
Job# 1855

DRAWING / SHEET NUMBER
Plat #01

SEC:2 & 3 TWP:12 RANGE:13 TWP:Wayne CO:Muskingum ST:Ohio