

DESCRIPTION OF SURVEY FOR PAULINE BUTLER

JOB#2028-2

Situated in the State of Ohio, County of Muskingum, Township of Wayne:

Being part of Southeast Quarter, Section 7, Township 12, Range 13, of the Congress Lands East of the Scioto River, further **being a strip** lying between the center line of North Dietz Lane and the West lines of the Pauline Butler property recorded in Official Record Volume 2378, Page 555, of said county's deed records, and more particularly described as follows;

Commencing at an iron pin (set) at the Center of Section 7;

- TIE- THENCE South 86 degrees 48 minutes 45 seconds East 904.38 feet** along the common line for the Southeast and Northeast Quarters of Section 7, to the unmarked Northeast corner of the Ann Rittberger Trustee property recorded in Deed Book Volume 1143, Page 893, further being within the intersection of Lutz Lane and North Dietz Lane, and being the place of beginning for the property herein intended to be described;
- #1- THENCE South 86 degrees 48 minutes 45 seconds East 43.71 feet** continuing along said Quarter Section line, leaving said intersection to an unmarked point in an unnamed run, being the Northwest corner of said Pauline Butler property, from which an iron pin (set) for reference bears South 86 degrees 48 minutes 45 seconds East 15.00 feet;
- #2- THENCE South 05 degrees 32 minutes 13 seconds East 159.10 feet** into said Southeast Quarter of Section 7, and along said Pauline Butler property and unnamed run to an unmarked point;
- #3- THENCE South 48 degrees 23 minutes 21 seconds East 36.48 feet** continuing along said Pauline Butler property and unnamed run to an unmarked point, from which an iron pin (set) for reference bears South 71 degrees 04 minutes 15 seconds East 31.12 feet;
- #4- THENCE South 36 degrees 59 minutes 36 seconds West 40.05 feet** continuing along said Pauline Butler property and unnamed run to an unmarked point;
- #5- THENCE South 01 degrees 56 minutes 30 seconds West 47.55 feet** continuing along said Pauline Butler property and unnamed run to an unmarked point;
- #6- THENCE South 14 degrees 31 minutes 10 seconds West 205.69 feet** continuing along said Pauline Butler property and unnamed run to an unmarked point, from which an iron pin (set) for reference bears South 77 degrees 34 minutes 58 seconds East 23.64 feet;
- #7- THENCE South 17 degrees 34 minutes 01 seconds West 51.59 feet** continuing along said Pauline Butler property and unnamed run to an unmarked point;
- #8- THENCE South 10 degrees 09 minutes 08 seconds West 83.89 feet** continuing along said Pauline Butler property and unnamed run to an unmarked point;
- #9- THENCE South 04 degrees 52 minutes 36 seconds West 78.18 feet** continuing along said Pauline Butler property and unnamed run to an unmarked point, from which an iron pin (set) for reference bears South 55 degrees 29 minutes 41 seconds East 27.16 feet;
- #9- THENCE South 74 degrees 50 minutes 16 seconds West 37.10 feet** continuing along said Pauline Butler property and unnamed run to an unmarked point;
- #10- THENCE South 24 degrees 31 minutes 42 seconds West 25.02 feet** continuing along said Pauline Butler property and unnamed run to the unmarked Northeast corner of a second Pauline Butler property recorded in Deed Book Volume 1032, Page 433, from which an iron pin (set) for reference bears South 75 degrees 05 minutes 23 seconds East 36.76 feet;

73-18.04-80-000

- #11- **THENCE North 75 degrees 44 minutes 55 seconds West 26.00 feet** leaving said unnamed run and along said second Butler property to an unmarked point in the center line of North Dietz Lane, further being the Southeast corner of a third Pauline Butler property recorded in Deed Book Volume 700, Page 218;
- #12- **THENCE North 21 degrees 43 minutes 47 seconds East 176.49 feet** along said third Butler property and center line of road to an unmarked point;
- #13- **THENCE North 13 degrees 41 minutes 07 seconds East 73.05 feet** continuing along said Second Butler property and road to the unmarked common corner for said third Butler property and for the Andrew L R Rittberger property recorded in Deed Book Volume 1143, Page 895;
- #14- **THENCE North 13 degrees 41 minutes 07 seconds East 210.00 feet** continuing along said road and along said Andrew Rittberger property to an unmarked common corner for said Andrew Rittberger and Ann Rittberger properties;
- #15- **THENCE along a curve to the left having, an chord bearing of North 00 degrees 46 minutes 10 seconds East 117.90 feet, a radius of 237.50 feet, and arc length of 119.14 feet,** continuing along said road and along said Ann Rittberger property to an unmarked point;
- #16- **THENCE North 13 degrees 36 minutes 06 seconds West 146.63 feet** continuing along said road and along said Ann Rittberger property to the place of beginning, containing **0.50 acres**, of which 0.34 acres are within the right of way for North Dietz Lane.

The bearings within this description are based on State Plane Coordinate Grid (Ohio South 1983) derived from GPS Observations. Iron pins (set) are 5/8" rebar with identification caps (C.R.Harkness P.L.S.6885).

This description was written by Charles R. Harkness Professional Land Surveyor #6885 from an actual survey completed on January 21, 2013 in accordance with Chapter 4733-37 of the Administrative Code, and is intended to be used for the legal transfer of the property described and does not intend to describe all or any easements of record, unless otherwise indicated.

OFFICE COPY
NOT RECORDABLE
Charles R. Harkness P.L.S. #6885



DESCRIPTION
REVISED
[Signature] 1/24/2013

73-18-04-80-000

LEGEND

- PIN (SET) 5/8" REBAR CAP
(C R HARKNESS PLS#6885)
- PIN (FOUND)
- △ POINT (UNMARKED)

Carl Rittberger Sr. Inc.
DB Vol. 481, Page 546.

Andrew L Rittberger
DB Vol. 1143, Page 895.

Pauline Butler
DB Vol. 700, Page 218.

Pauline Butler
DB Vol. 1032, Page 433.

Pauline Butler
OR Vol. 2378, Page 555.

Forest Hills PB 14, Page 105.

Carl Rittberger Sr. Inc.
DB Vol. 490, Page 296.

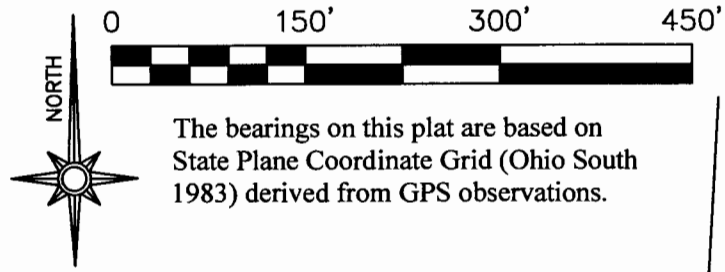

The bearings on this plat are based on State Plane Coordinate Grid (Ohio South 1983) derived from GPS observations.

Situated in the State of Ohio, County of Muskingum, Township of Wayne:

Being part of Southeast Quarter, Section 7, Township 12, Range 13, of the Congress Lands East of the Scioto River, further being a strip lying between the center line of North Dietz Lane and the West lines of the Pauline Butler property recorded in Official Record Volume 2378, Page 555, of said county's deed records:

SURVEYOR'S NOTES AND REFERENCES:

Muskingum County Tax Maps and Orthophotos of the area. Survey of the Pauline Butler property recorded in OR Vol. 2378, Page 555 by Charles R Harkness PLS #6885 date Jan 14, 2013 (Job 2028-1)

Note #1- The surveyed parcel has been used in connection with the Pauline Butler property recorded in OR Vol. 2378, Page 555 for more then 70 years.

This plat was prepared by C.R. Harkness Surveying & Mapping Inc. in accordance with Chapter 4733-37 of the Administrative Code, and is intended to be used for the legal transfer of the parcel surveyed and does not show all or any easments of record, unless otherwise indicated.

OFFICE COPY
NOT RECORDABLE

SURVEY FOR:	
Pauline Butler Estate	
Survey Date: Jan 21, 2013	Drawn Date: Jan 22, 2013
C R HARKNESS SURVEYING & MAPPING, INC.	
8205 OLD TOWN ROAD, ROSEVILLE, OHIO 43777	
PHONE/FAX (740) 849-0122	
Job Number: Job #2028	Drawing/Sheet No. Plat #02



Center Sec 7
S 02°15'22" W 264.14'
Replacing Pin Found Disturbed

S 86°48'45" E 904.38'

Curve Left Chord Bearing
N 00°46'10" E 117.90'
Rad=237.50' Arc=119.14'

N 13°41'07" E 210.00'
RW 20 Feet 0.34 Acres.
Passing 25.00'

N 13°41'07" E 73.05'

N 21°43'47" E 176.49'

N 75°44'55" E 806.36' To Pin Set
Passing 25.00'

S 04°52'36" W 78.18'
S 55°29'41" E 27.16' Ref Pin
S 74°50'16" W 37.10'
S 24°31'42" W 25.02'

S 75°05'23" E 36.76' Ref Pin

S 05°32'13" E 159.10'
S 48°23'21" E 36.48'

S 71°04'15" E 31.12' Ref Pin
S 36°59'36" W 40.05'
S 01°56'30" W 47.55'

0.50 Acres

Passing 15.00' S 86°48'45" E 1710.21' To Pin (Found) at Qtr Sec Corner

POB
S 86°48'45" E 43.71'

Ann Rittberger Trustee
DB Vol. 1143, Page 893.
Unnamed Run

Lutz Lane

Unnamed Run
North Dietz Lane

Lot 1

Lot 2

Lot 3