

Thence with the south line of said Section 18, N 87°40'30" W a distance of 1255.98 feet to the principal place of beginning, containing a total of 85.447 acres more or less, subject to all legal highways and easements of record.

All bearings described herein are based on the Ohio State Plane Grid Coordinates, NAD83, Ohio South per GPS Observation.

All iron pins set are 5/8 inch by 30 inch steel rebar with plastic identification caps marked MCPEEK PS8517.

The above described 85.447 acre parcel is based on a field survey made by Brian K. McPeck, PS 8517 of McPeck Land Surveying, LLC on January 12th, 2022.

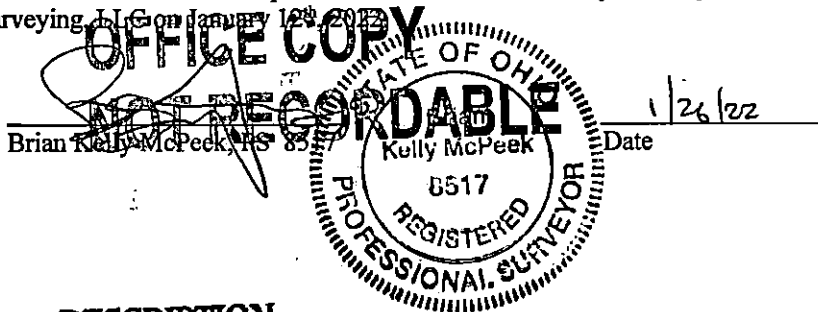

DESCRIPTION

APPROVED

By: [Signature] 1/26/22