



www.mcpeeklandsurveying.com
email: brian@mcpeeklandsurveying.com
1705 East Pike, * Zanesville, Oh 43701 * 740.704.6073

Muskingum County Land Reutilization Corporation

OR 3109-325

+/-0.252 Ac.

All of: 81-07-01-07-000 (+/- 0.231 Ac.)

All of: 81-07-01-08-000 (+/- 0.021 Ac.)

Situated in the State of Ohio, County of Muskingum, City of Zanesville, Part of Lot 102 of the Town of Putnam (PB A-O, Page 2) and being all of the lands now owned by Muskingum County Land Reutilization Corporation (MCLRC) as recorded in OR 3109-325 of the Muskingum County Recorders Office and more fully described as follows.

Beginning for reference at a point at the intersection of the north line of Lincoln Street (50') and the east line of Moxahala Avenue (66'), thence with the east line of said Moxahala Avenue, N 01°33'25" W a distance of 306.04 feet to a point at the northwest corner of the lands now owned by Charles H. Sr., & Jessie I. Goins (DR 990-173), the principal place of beginning;

thence continuing with the east line of said Moxahala Avenue, N 01°33'25" W a distance of 62.63 feet to an iron pin found (5/8") at the southwest corner of the lands now owned by Jeffrey S. A. Curtis (OR 3007-627);

thence with the south line of said Curtis' lands, N 88°33'41" E a distance of 174.28 feet to an iron pin found (5/8") on the west line of Slate Alley (16');;

thence with the west line of said Slate Alley, S 01°19'41" E a distance of 63.27 feet to an iron pin set at the southeast corner of said MCLRC's lands, passing an iron pin found (1") at 58.27 feet;

thence with the south line of said MCLRC's lands, S 88°46'24" W a distance of 174.03 feet to the place of beginning, passing a pipe found (1") at 173.33 feet, containing 0.252 acres more or less, subject to all legal highways and easements of record.

All bearings described herein are based on the Ohio State Plane Grid Coordinates, NAD83, Ohio South per GPS Observation.

All iron pins set are 5/8 inch by 30 inch steel rebar with plastic identification caps marked MCPEEK PS8517.

The above described 0.252 acre parcel is based on a field survey made by McPeek Land Surveying on August 28, 2023.

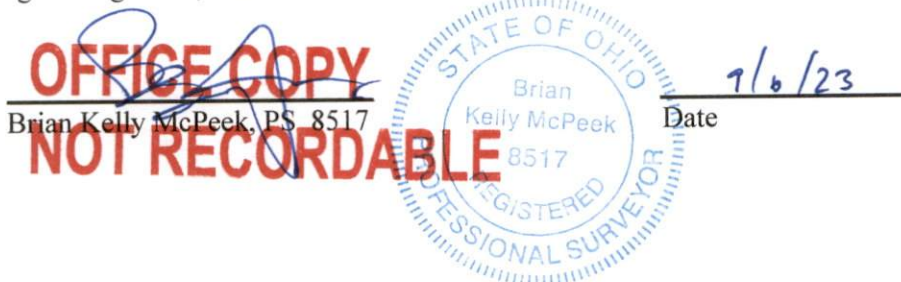

DESCRIPTION

APPROVED

By: MB 9-12-2023