



www.mcpeeklandsurveying.com
email: brian@mcpeeklandsurveying.com
1705 East Pike, * Zanesville, Oh 43701 * 740.704.6073

ADF, LLC.

OR 2951-463

All of : 83-26-03-08-000 (+/- 0.107 Ac.)

OR 3138-716

All of : 83-25-06-15-000 (+/- 0.120 Ac.), All of : 83-25-06-03-000 (+/- 0.519 Ac.), All of : 83-25-06-01-000 (+/- 0.333 Ac.) and All of : 83-26-03-09-000 (+/- 0.045 Ac.)

Total +/-1.124 Acres

Situated in the State of Ohio, County of Muskingum, City of Zanesville, Part of Lots 77, 78 and 79, all being in Charles C. Russell's Subdivision of The Safford Farm as recorded in PB 2, PG 1, Lots 64-92, being all of the lands now owned by ADF, LLC recorded in OR 2951-463 and 3138-716 in the Muskingum County Recorder's office more fully described as follows.

Beginning for reference at an iron pin found on the southwest corner of Lot 64 in said Russell's Sub.; thence N 62°44'06" E a distance of 431.72 feet to an axle found, the principal place of beginning. thence with the north line of said ADF's lands, S 86°55'29" E a distance of 25.00 feet to an axle found; thence with the north line of said ADF's (OR 2951-463) parcel, S 66°36'09" E a distance of 287.94 feet to an iron pin set at the northeast corner of said ADF's lands (OR 3138-716); thence with the east line of said ADF's lands (OR 3138-716) S 00°41'04" W a distance of 111.97 feet to an iron pin set on the north line of Crown Street (33'); thence with the south line of said ADF's lands (OR 3138-716) N 86°28'03" W a distance of 300.78 feet to an axle found at the southwest corner of Lot 77; thence with the west line of Lot 77 N 03°22'22" E a distance of 209.47 feet to the place of beginning, containing 1.124 acres more or less, subject to all legal highways and easements of record.

All bearings described herein are based on the Ohio State Plane Grid Coordinates, NAD83, Ohio South per GPS Observation.

All iron pins set are 5/8 inch by 30 inch steel rebar with plastic identification caps marked MCPEEK PS8517.

The above described 1.124 acre parcel is based on a field survey made by Brian K. McPeek, PS 8517 of McPeek Land Surveying, LLC on May 23rd, 2024.

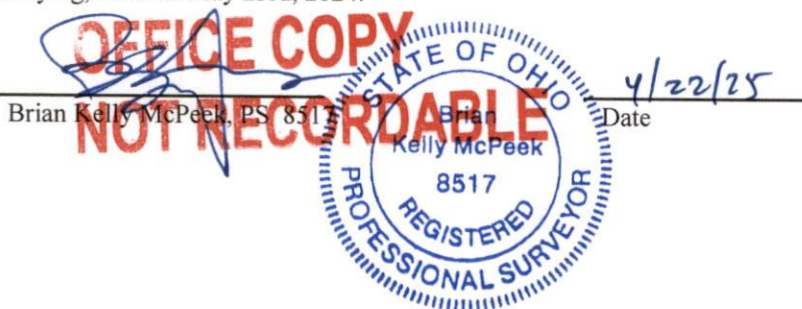

DESCRIPTION

APPROVED

By: [Signature]