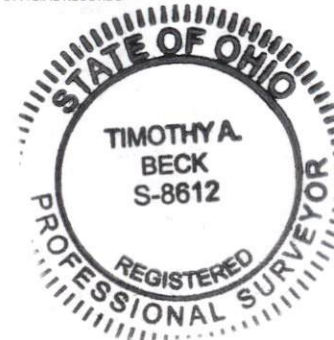

## SURVEY OF ACREAGE

SITUATED IN THE CITY OF ZANESVILLE, COUNTY OF MUSKINGUM AND STATE OF OHIO, AND BEING PART OF THOSE CERTAIN LANDS GRANTED TO STORE IT LLC BY DEED IN VOLUME 2384, PAGE 575 OF OFFICIAL RECORDS KNOWN AS TRACT ONE-PARCEL ONE, TRACT ONE-PARCEL TWO, TRACT TWO, TRACT THREE-PARCEL NO. 1, TRACT THREE-PARCEL NO. 2, TRACT THREE-PARCEL NO. 3, TRACT THREE-PARCEL NO. 4, TRACT FOUR, TRACT FIVE, TRACT SIX, TRACT SEVEN, TRACT EIGHT, TRACT NINE, TRACT TEN, TRACT ELEVEN, TRACT TWELVE, TRACT THIRTEEN, TRACT FOURTEEN, TRACT FIFTEEN, TRACT SIXTEEN, AND BY DEED IN VOLUME 2867, PAGE 351 OF OFFICIAL RECORDS KNOWN AS TRACT ONE-PARCEL ONE, TRACT ONE-PARCEL TWO, TRACT ONE-PARCEL THREE AND TRACT ONE-PARCEL FOUR, BEING LOTS 6 THROUGH 8 (SQUARE 16), LOTS 13 THROUGH 16 (SQUARE 16), 1 THROUGH 12 (SQUARE 17), LOTS 1 THROUGH 12 (SQUARE 21) AND LOTS 1 THROUGH 12 (SQUARE 24) OF WESTERN ADDITION TO THE CITY OF ZANESVILLE AS PER MAP RECORDED IN REPLAT BOOK 1, PAGE 4 AND 5, VACATION OF PEARL STREET AS PER BOOK 195, PAGE 188 AND BOOK 410, PAGE 147, PARTIAL VACATION OF RAILROAD STREET AS PER BOOK 1159, PAGE 291, PARTIAL VACATION OF BEECH STREET AS PER BOOK 2912, PAGE 19, PARTIAL VACATION OF WALNUT STREET AS PER BOOK 662, PAGE 285 AND VACATED ALLEYS AS PER BOOK 970, PAGE 325 AND BOOK 2912, PAGE 19 OF OFFICIAL RECORDS

DESCRIPTION  
APPROVEDBy: *J.M. Barnard*  
3-6-2025OFFICE COPY  
NOT RECORDABLE

PROFESSIONAL LAND SURVEYOR  
PROJECT NO. 2421470-52108  
SURVEY PREPARED BY:  
AMERICAN SURVEYING & MAPPING, INC.  
221 CIRCLE DRIVE, MARYLAND, PA. 32751  
PHONE: (407) 428-9797  
FAX: (407) 428-9741  
INFO@ASM-CORPORATE.COM

THIS DOCUMENT SHOULD BE CONSIDERED INVALID WITHOUT A LICENSED SURVEYOR'S SIGNATURE AND SEAL.

SURVEY OF ACREAGE  
120 STATE STREET  
MUSKINGUM COUNTY  
ZANESVILLE, OHIO

**ASM** AMERICAN SURVEYING & MAPPING, INC.  
NDDSS NATIONAL DIGITAL SURVEYING SERVICES  
221 CIRCLE DRIVE, MARYLAND, PA. 32751  
Phone: (407) 428-9797  
www.asm-surveying.com

LINE TABLE(R)(C)			LINE TABLE(R)(C)		
LINE #	DIRECTION	LENGTH	LINE #	DIRECTION	LENGTH
L1(R)	S48°55'07"E	346.93'	L36	S51°18'22"E(C)	316.00'(C)
(C)	S48°54'51"E		L37	S38°45'00"W(C)	25.00'(C)
L2	S42°54'30"W	283.80'	L38	S38°45'00"W(C)	126.41'(C)
(C)	S42°55'06"W		L39	N82°21'45"W(C)	109.07'(R)(C)
L3	N31°20'40"W	41.66'	L40	N82°22'07"W(C)	112.91'(R)(C)
(C)	N31°20'24"W		L41	S83°30'40"W(C)	234.74'(R)(C)
L4	N38°41'53"E	60.06'	L42	S54°24'28"W(C)	188.03'(C)
(C)	N38°42'09"E		L43	S53°35'00"W(C)	178.41'(R)(C)
L5	N51°15'00"W	31.07'	L44	S53°35'00"W(C)	85.98'(R)(C)
(C)	N51°14'44"W		L45	N77°59'13"W(C)	72.41'(R)(C)
L6	N13°31'48"W	128.39'	L46	N58°50'03"W(C)	155.43'(R)(C)
(C)	N13°31'32"W		L47	N44°38'57"W(C)	73.67'(R)(C)
L7	N28°12'11"W	39.69'	L48	N31°17'11"W(C)	119.70'(C)
(C)	N28°11'55"W		L49	N38°45'00"E(C)	88.10'(C)
L8	N35°57'30"W	41.47'	L50	N51°21'07"W(C)	120.00'(C)
(C)	N35°57'34"W		L51	S38°45'00"W(C)	119.66'(C)
L9	N35°57'30"W	41.47'	L52	N51°21'37"E(C)	120.00'(C)
(C)	N35°57'34"W		L53	N51°21'37"E(C)	180.00'(C)
L10	N49°52'48"W	40.01'	L54	N38°42'35"E(C)	120.93'(C)
(C)	N49°52'32"W		L55	S51°12'13"E(C)	160.09'(C)
L11	N38°45'00"E	100.00'	L56	S38°45'00"W(R)	120.93'(C)
(C)	N38°45'16"E		L57	S38°45'00"W(R)	171.03'(C)
L12	N38°45'00"E	171.03'	L58	N51°15'00"W(C)	30.00'(C)
L13	S07°55'00"W	17.29'	L59	N38°45'00"E(R)	188.00'(C)
(C)	S19°33'00"W		L60	S51°15'00"E(C)	19.00'(C)
L14	S19°33'00"W	100.00'	L61	S33°35'22"W(C)	38.84'(C)
(C)	S37°06'00"W		L62	S33°35'00"W(R)	
L15	S37°06'00"W	100.00'			
(C)	S50°29'00"W				
L16	S50°29'00"W	100.00'			
(C)	N51°15'00"W				
L17	N51°15'00"W	24.52'			
(C)	N38°45'00"E				
L18	N38°45'00"E	136.00'			
(C)	N38°45'00"E				
L19	N38°45'00"E	120.00'			
(C)	S29°40'00"E				
L20	S29°40'00"E	43.01'			
(C)	S21°46'00"E				
L21	S21°46'00"E	45.95'			
(C)	S13°08'00"E				
L22	S13°08'00"E	50.84'			
(C)	S38°45'00"W				
L23	S38°45'00"W	50.17'			
(C)	N51°15'00"W				
L24	N51°15'00"W	120.00'			
(C)	S51°15'00"E				
L25	S51°15'00"E	30.00'			
(C)	S38°45'00"W				
L26	S38°45'00"W	136.00'			
(C)	N51°15'00"W				
L27	N51°15'00"W	30.00'			
(C)	N38°45'00"E				
L28	N38°45'00"E	136.00'			
(C)	S38°45'00"W				
L29	S38°45'00"W	120.00'			
(C)	S51°15'00"E				
L30	S51°15'00"E	120.00'			
(C)	N38°45'00"E				
L31	N38°45'00"E	50.17'			
(C)	S01°22'00"E				
L32	S01°22'00"E	76.10'			
(C)	N51°15'00"W				
L33	N51°15'00"W	177.04'			
(C)	N38°45'00"E				
L34	N38°45'00"E	128.00'			
(C)	S51°15'00"E				
L35	S51°15'00"E	8.00'			



TABLE OF SUBJECT PARCELS	
OWNER: STORE IT LLC BOOK 2384, PAGE 575 & BOOK 2867, PAGE 351	
1	ALL OF PARCEL 1 83-37-03-01-000 AREA=2.531 ACRES
2	ALL OF PARCEL 2 83-32-02-01-000 AREA=12.550 ACRES
3	ALL OF PARCEL 3 83-37-03-02-000 AREA=0.348 ACRES
4	ALL OF PARCEL 4 83-37-03-03-000 AREA=0.077 ACRES
5	ALL OF PARCEL 5 83-37-03-04-000 AREA=0.185 ACRES
6	ALL OF PARCEL 6 83-37-03-05-000 AREA=0.237 ACRES
7	ALL OF PARCEL 7 83-37-03-15-000 AREA=0.118 ACRES
8	ALL OF PARCEL 8 83-37-03-08-000 AREA=0.140 ACRES
9	ALL OF PARCEL 9 83-37-03-08-000 AREA=0.140 ACRES
10	ALL OF PARCEL 10 83-37-03-07-000 AREA=0.140 ACRES
11	ALL OF PARCEL 11 83-37-03-11-000 AREA=0.202 ACRES
12	ALL OF PARCEL 12 83-37-03-12-000 AREA=0.173 ACRES

TABLE OF SUBJECT PARCELS	
OWNER: STORE IT LLC BOOK 2384, PAGE 575 & BOOK 2867, PAGE 351	
13	ALL OF PARCEL 13 83-37-03-01-000 AREA=0.088 ACRES
14	ALL OF PARCEL 14 83-37-03-14-000 AREA=0.118 ACRES
15	ALL OF PARCEL 15 83-37-03-13-000 AREA=0.858 ACRES
16	ALL OF PARCEL 16 83-38-02-06-000 AREA=0.110 ACRES
17	ALL OF PARCEL 17 83-38-02-07-000 AREA=0.110 ACRES
18	ALL OF PARCEL 18 83-38-02-08-000 AREA=0.110 ACRES
19	ALL OF PARCEL 19 83-38-02-08-000 AREA=0.110 ACRES
20	ALL OF PARCEL 20 83-38-02-12-000 AREA=0.110 ACRES
21	ALL OF PARCEL 21 83-38-02-11-000 AREA=0.110 ACRES
22	ALL OF PARCEL 22 83-38-02-10-000 AREA=0.110 ACRES
23	ALL OF PARCEL 23 83-37-03-06-000 AREA=1.133 ACRES
24	ALL OF PARCEL 24 83-37-03-18-000 AREA=0.108 ACRES

## LEGEND AND ABBREVIATIONS

(C) CALCULATED DATA	○ RECORDED INSTRUMENT AS NOTED
(D) BOOK 3131, PAGES 743-747	--- PLATTED CENTERLINE (VACATED AS NOTED)
(H) FIELD MEASURED DATA	--- PLATTED LOT LINE
(N) NUMBER	--- PLATTED RIGHT OF WAY LINE
(P) POINT OF BEGINNING	--- ADJOINING PARCEL LINE
(POB) POINT OF COMMENCEMENT	--- BOUNDARY LINE
(R) RECORD DESCRIPTION	
(T) WESTING DEED TRACT NUMBER	

## LAND AREA

SOUTHEAST PARCEL (LEGAL 1):	833,740± SQUARE FEET	19.140± ACRES
NORTHWEST PARCEL A (LEGAL 2):	14,360± SQUARE FEET	0.330± ACRES
NORTHWEST PARCEL B (LEGAL 3):	19,354± SQUARE FEET	0.440± ACRES
TOTAL AREA:	953,854± SQUARE FEET	19.910± ACRES

## BEARING BASIS

BEARINGS SHOWN HEREON ARE BASED ON SOUTHEASTERLY RIGHT OF WAY LINE OF STATE STREET, WHICH BEARS NORTH 38°45'00" EAST, PER REPLAT OF WESTERN ADDITION BOOK 1, PAGES 4 AND 5.