

thence along the east line of lands now or formerly owned by Mansor Family Company, LLC as described in Official Record 1777-427 and lands now or formerly owned by Catherine Rebecca Rogers as described in Official Record 2059-580, North 01 degrees 32 minutes 58 seconds East 200.93 feet to the place of beginning, passing the northwest corner of said Maria Adornetto Restaurant, Inc. land described in Deed Record 662-57, First Parcel at 108.1 feet, containing 0.45 acres more or less, subject to all legal road right of ways and applicable easements, written or implied.

Subject to the right of way or use by the owners of the property adjacent to and upon the North and East of the lands described in Deed Record 662-57, First Parcel of a portion of said land upon the Northerly end approximately 3.1 feet in width and extending across the entire Northerly end. There is also granted as an appurtenance to said property the right to use a private alley running Southwardly from Market Street. Said private alley is described in Deed Record 761-1 as a strip of land 4.5 feet wide off the west side of the lot together with the right to travel over and an easement upon a strip of ground 4.5 feet wide immediately adjoining said premises on the west.

There is also granted an easement over a strip across the south end of lands described in Deed Record 761-1 being 13.4 feet wide at its west end and 11.4 feet wide on its east end.

Iron pins set are 5/8 inch diameter by 30 inch long rebar with a plastic identification cap.

Bearings are based on Ohio State Plane Coordinate System, South Zone from GPS observations made on October 26 and December 20, 2012.

This description is written based on a survey completed January 21, 2013 by Timothy H. Linn, Reg. No. 7113.

~~OFFICE COPY~~
Timothy H. Linn, Reg. No. 7113
NOT RECORDABLE

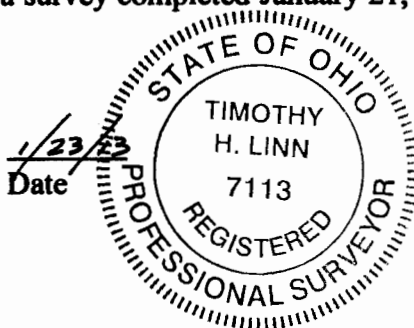

PARCEL NO.:

All of Parcel No.: 80-84-26-05-22-000 (0.050 ac)

All of Parcel No.: 80-84-26-05-23-000 (0.052 ac)

All of Parcel No.: 80-84-26-05-24-000 (0.115 ac)

All of Parcel No.: 80-84-26-05-41-000 (0.092 ac)

All of Parcel No.: 80-84-26-05-42-000 (0.032 ac)

All of Parcel No.: 80-84-26-05-43-000 (0.117 ac)

Area in parentheses is per the Auditor records and totals 0.458 acres.

Total area per survey is 0.45 acres.

DESCRIPTION

APPROVED

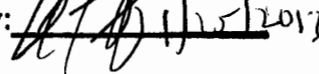
By:  1/25/2013