

July 17, 2009
Revised: July 27th, 2009
Project Number: 09-121

1308 Henry Street, Zanesville
Parcel 2 (continued)

Course No 1: thence, **South 89°-58'-43" West**, along said northerly line, a distance of **60.00 feet** to an iron pin set;

Course No. 2: thence, **North 00°-01'-13" East**, a distance of **112.50 feet** to an iron pin set on the northerly line of Lot 1 and the southerly line of Henry Street (28 feet wide) (a 1-inch iron pipe in concrete was found South 89°-58'-43" West at 161.95 feet along the southerly line of Henry Street);

Course No. 3: thence, **North 89°-58'-43" East**, along the northerly line of Lot 1 and the southerly line of Henry Street, a distance of **60.00 feet** to an iron pin set at the northeasterly corner of Lot 1 and the westerly line of Goddard Street (a 1-inch iron pipe in concrete was found North 89°-58'-43" East at 33.00 feet at the intersection of the easterly line of Goddard Street and southerly line of Henry Street);

Course No. 4: thence, **South 00°-01'-13" West**, along the easterly line of Lot 1 and the westerly line of Goddard Street, a distance of **112.50 feet** to the place of beginning, and containing **0.071 acre** of land more or less, as surveyed in July of 2009 by Robert A. Dorner, Registered Professional Land Surveyor No. 6943 for and on behalf of **McSteen & Associates, Inc.** under Project No. 09-1121 and being subject to all legal highways and easements of record.

The basis of bearings for this legal description is South 00°-00'-00" West as the northerly line of Playford Avenue, as evidenced by monuments found, and is the same bearing as shown on a Map of Survey dated 5/14/91 by R.L. Daniels and Associates. All iron pins noted as set are 30-inch, long 5/8-inch rebar with an identification cap stamped "McSTEEN 7104".

Parcel 3 (Parcel No. 84-39-02-02-000)

Situated in the State of Ohio, County of Muskingum, City of Zanesville, being part of Lot 1 in Blandy's Hill Addition to the City of Zanesville as recorded in Book 2, Page 18 of the Muskingum County Records of Plats, being parcels of land, now or formerly in the name of Wells Fargo Financial Ohio 1, Inc., as recorded in Book 2208, Page 522 of the Muskingum County Records of Deeds, and more fully described as follows:

Cuyahoga Falls • Painesville • Wickliffe
Corporate Office: 1415 East 286th Street Wickliffe, Ohio 44092

440.585.9800 Toll Free: 800.250.3451 Mortgage Fax 440.585.9801 Survey Fax 440.585.9802
www.mcsteen.com

July 17, 2009
Project Number: 09-121

1308 Henry Street, Zanesville
Parcel 3 (continued)

Commencing for Reference at a $\frac{3}{4}$ -inch rebar found at the southeasterly corner of said Lot 1 and at the intersection of the northerly right-of-way line of Playford Avenue (40 feet wide) with the westerly right-of-way line of Goddard Street (33 feet wide) (a $\frac{5}{8}$ -inch rebar was found South $90^{\circ}-00'-00''$ West at 235.50 feet on the northerly line of Playford Avenue); Thence, North $00^{\circ}-01'-13''$ East, along the westerly line of Goddard

Street and the easterly line of Lot 1, passing over an iron pin set at 124.80 feet, a distance of 237.30 feet to an iron pin set at the northeasterly corner of Lot 1 on the southerly line of Henry Street (a 1-inch iron pipe in concrete was found North $89^{\circ}-58'-43''$ East at 33.00 feet at the intersection of the easterly line of Goddard Street and southerly line of Henry Street); Thence, South $89^{\circ}-58'-43''$ West, along the northerly line of Lot 1 and southerly line of Henry Street, a distance of 60.00 feet to an iron pin set at the **TRUE PLACE of BEGINNING** of the parcel herein to be described:

Course No. 1: thence, **South $00^{\circ}-01'-13''$ West**, a distance of **112.50 feet** to an iron pin set on the northerly line of a Private Alley (unspecified width) (ownership unknown);

Course No. 2: thence, **South $89^{\circ}-58'-43''$ West**, along the northerly line of said Private Alley, a distance of **63.50 feet** to an iron pin;

Course No. 3: thence, **North $00^{\circ}-01'-13''$ East**, a distance of **112.50 feet** to an iron pin set on the northerly line of Lot 1 and the southerly line of Henry Street (a 1-inch pipe in concrete was found South $89^{\circ}-58'-43''$ West at 98.45 feet along the southerly line of Henry Street);

Course No. 4: thence, **North $89^{\circ}-58'-43''$ East**, along the northerly line of Lot 1 and the southerly line of Henry Street, a distance of **63.50 feet** to the place of beginning, and containing **0.149 acre** of land more or less, as surveyed in July of 2009 by Robert A. Dorner, Registered Professional Land Surveyor No. 6943 for and on behalf of **McSteen & Associates, Inc.** under Project No. 09-1121 and being subject to all legal highways and easements of record.

The basis of bearings for this legal description is South $00^{\circ}-00'-00''$ West as the northerly line of Playford Avenue, as evidenced by monuments found, and is the same bearing as shown on a Map of Survey dated 5/14/91 by R.L. Daniels and Associates. All iron pins noted as set are 30-inch, long $\frac{5}{8}$ -inch rebar with an identification cap stamped "McSTEEN 7104".

Cuyahoga Falls • Painesville • Wickliffe
Corporate Office: 1415 East 286th Street Wickliffe, Ohio 44092

440.585.9800 Toll Free: 800.250.3451 Mortgage Fax 440.585.9801 Survey Fax 440.585.9802
www.mcsteen.com

**OFFICE COPY
NOT RECORDABLE**

DESCRIPTION

APPROVED

By:

[Signature] 7/27/2009

HENRY STREET
28' Right Of Way

N 89°58'43" E 222.50' REC. & USED

BOUNDARY SURVEY
for
1308 HENRY STREET

Known as being Part of Lot 1 of Blandys Hill Addition to the City of Zanesville, recorded in Plat Book 2, Pg. 18, Muskingum County Record of Plats, now situated in the

CITY OF ZANESVILLE
COUNTY OF MUSKINGUM - STATE OF OHIO

by
McSTEEN & ASSOCIATES, INC.
ENGINEERS & SURVEYORS
1415 East 286th Street
Wickliffe, Ohio 44092
(440) 585-9800

The basis of bearings for this survey is S 90°00'00" W as the northerly line of Playford Avenue, as evidenced by monuments found, and is the same bearing as shown on a Map of Survey dated 5/14/91 by R.L. Daniels & Associates. Distances are given in feet and decimal parts thereof. All iron pins shown as set are 30" long 5/8" rebar with an identification cap stamped "McSteen".

OFFICE COPY
NOT RECORDABLE
7/27/09

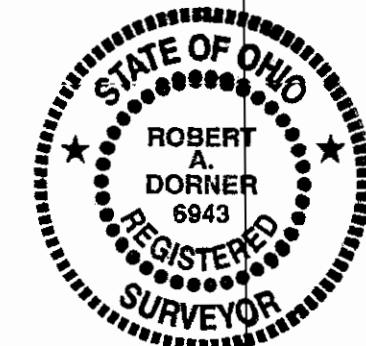

REG. PROF. SURV. No. 6943
Job No.: 09-121
Field Date: July 13, 2009
Survey Date: July 20, 2009
Latest Revision Date:
Previous Reference Job No.:



GRAPHIC SCALE



(IN FEET)
1 inch = 20 ft.

- denotes iron pin found as noted
- denotes iron pipe found as noted
- ⊙ denotes 5/8" diameter x 30" long iron pin with "McSTEEN 7104" ID cap set

DESCRIPTION

APPROVED
By: [Signature] 7/27/09

