



www.mcpeeklandsurveying.com  
email: brian@mcpeeklandsurveying.com  
340 Robin Hood Ln., \* Zanesville, Oh 43701 \* 740.704.6073

**Knellinger Herron Properties, LLC**  
**OR 2847-812**  
**+/- 0.110 Ac.**

Situated in the State of Ohio, County of Muskingum, City of Zanesville and being all of Lot 22 in Tiledale Addition to the City of Zanesville as recorded in Plat Book 2, Page 114 of the Muskingum County Recorders Office and more particularly described as follows.

Beginning at an iron pin set at the southwesterly corner of said Lot 22, thence with the east side of an alley (15'), N 27°53'42" E a distance of 40.00 feet to an iron pin set on the northwest corner of said Lot;  
thence with the common line of said Lots 22 & 21, S 61°46'19" E a distance of 119.63 feet to an "x" in concrete on the westerly line of Linden Avenue;  
thence with the west line of said Linden Avenue, S 27°53'11" W a distance of 40.00 feet to a point at the southeast corner of said Lot 22, passing an iron pin found at 39.28 feet;  
thence with the common line of said Lots 22 & 23, N 61°46'19" W a distance of 119.64 feet to the place of beginning, containing a total of 0.110 acres, more or less, subject to all legal highways and easements of record.

All bearings described herein are based on the Ohio State Plane Grid Coordinates, NAD83, Ohio South per GPS Observation.

All iron pins set are 5/8 inch by 30 inch steel rebar with plastic identification caps marked MCPEEK PS8517.

The above described 0.110 acre parcel is based on a field survey made by Brian K. McPeek, PS 8517 of McPeek Land Surveying, LLC on August 7<sup>th</sup>, 2019.

**Parcel No.**

All of: 85-25-01-27-000 (+/-0.110 Ac.)

Brian Kelly McPeek, PS 8517

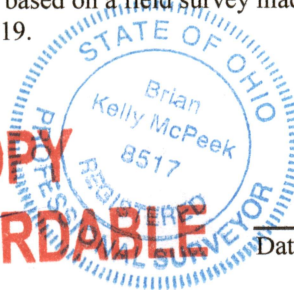

**OFFICE COPY**  
**NOT RECORDABLE**

Date

8/9/19

DESCRIPTION

APPROVED

By: Brian Kelly McPeek