

DESCRIPTION FOR 21.310 ACRE PARCEL

Situated in the State of Ohio, County of Muskingum, City of Zanesville, Quarter Township 1, Township 1, Range 8, being a part of Lot 5, Sibley's Subdivision, Plat Book 16, Page 88, and being a part of 49.67 acre tract as conveyed to the Zanesville-Muskingum County Port Authority by deed of record in Volume 1110, Page 28, all references being to those of record in the Recorder's Office, Licking County, Ohio, said 21.310 acres being more particularly bounded and described as follows:

Commencing at a iron pin found at the intersection of the westerly right-of-way line of Northpointe Drive and the northeasterly corner of 10.5507 acre tract as conveyed to Autumn Health Care of Zanesville, LLC. by deed of record in Volume 2059, Page 14;

Thence along the northerly line of said Autumn Health Care of Zanesville, LLC. tract, **North 52°43'52" West, 541.53 feet** to an iron pin found and the **Point of Beginning** of the parcel herein described;

Thence continuing along the northerly line of said Autumn Health Care of Zanesville, LLC. tract, **South 84°11'49" West, 564.04 feet** to a point, said point being North 17°20'37" West, 2.02 feet from an iron pin found;

Thence along the easterly line of a 104.2 acre tract as conveyed to Robert Dale Vandebark by deed of record in Volume 1542, Page 850, **North 02°00'50" East, 1,736.01 feet** to an iron pin found in the southerly right-of-way line of Fairview Road;

Thence leaving the aforesaid easterly line and along the southerly right-of-way line of said Fairview Road, with a curve to the left having a **radius of 580.00 feet** and an **arc length of 103.70 feet**, said curve having a **chord bearing of North 75°51'59" East** and a **chord length of 103.56 feet** and being subtended by a **delta of 10°14'38"** to an iron pin found at the northwesterly corner of a 3.491 acre tract as conveyed to Strumco Partners, LLC. by deed of record in Volume 1145, Page 403;

Thence leaving the said southerly right-of-way line and along the westerly line of the aforesaid Strumco Partners, LLC. tract, **South 01°57'24" West, 447.08 feet** to an iron pin found at the southwesterly corner of said Strumco Partners, LLC. tract;

Thence along the southerly line of said Strumco Partners, LLC. tract, **South 88°01'47" East, 315.00 feet** to an iron pin found at the southeasterly corner of said Strumco Partners, LLC. tract;

Thence along the easterly line of said Strumco Partners, LLC. tract, **North 01°57'24" East, 410.04 feet** to an iron pin found at the northeasterly corner of said Strumco Partners, LLC. tract;

Thence **South 68°42'25" East, 295.86 feet** to an iron pin found;

Thence **South 23°02'21" East, 533.99 feet** to an iron pin found;

Thence **North 77°03'44" West, 149.28 feet** to an iron pin set;

Thence **South 21°17'59" West, 281.14 feet** to an iron pin set;

Thence **North 68°33'54" West, 223.98 feet** to an iron pin set;

Thence **South 01°36'00" West, 719.68 feet** to an iron pin set;

Thence **North 89°45'12" East, 206.07 feet** to an iron pin set;

Thence **South 75°28'08" East, 21.68 feet** to an iron pin set;

Thence **South 16°53'34" West, 168.93 feet** to an iron pin set;

Thence **North 52°43'52" West, 65.09 feet** to an iron pin found;

Thence **South 37°16'08" West, 80.00 feet** to the **Point of Beginning** and containing **21.310 acres**, more or less, according to a survey conducted by Jobes Henderson and Assoc. in 2007.

The above described area is contained within Muskingum County Auditor Parcel Number 91-86-34-01-01-000.

The bearings in the above description are based on the Ohio State Plane Coordinate System, Ohio South Zone, NAD83.

All iron pins set are 5/8" rebar by 30 inches in length with red surveyors identification caps marked "J&H, PS 8283".

Subject to all valid and existing easements, restrictions and conditions of record.

May 17, 2007

P:\M04-53\survey\legals\21.310 acres.doc



**OFFICE COPY
NOT RECORDABLE**
Jeremy L. Van Ostran
Surveyor No. 8283

APPROVED FOR CLOSURE

[Signature] 5/17/2007

EXEMPT FROM
PLANNING COMMISSION

[Signature] 5/17/2007

≡ **SURVEY OF A 21.310 ACRE TRACT** ≡ SITUATED IN THE STATE OF OHIO, COUNTY OF MUSKINGUM, CITY OF ZANESVILLE

EXEMPT FROM
PLANNING COMMISSION

APPROVED FOR CLOSURE

[Signature] 5/9/2007

[Signature] 5/9/2007

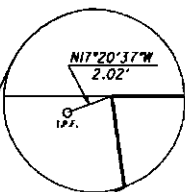

ROBERT DALE VANDENBARK
VOL. 1542, PAGE 850
104.2 ACRES

RADIUS = 580.00'
ARC LENGTH = 103.70'
DELTA = 10°M'38\"/>

AUTUMN HEALTH CARE
OF ZANESVILLE, LLC.
VOL. 2059, PAGE 14
10.5507 ACRES

ZANESVILLE-MUSKINGUM COUNTY PORT AUTHORITY
VOL. 1110, PAGE 28
49.67 ACRES
21.310 ACRES

INGRESS/EGRESS EASEMENT
50°57'24\"/>

FAIRVIEW ROAD

N52°43'52\"/>

P.O.B.

N52°43'52\"/>

P.O.C.

N52°43'52\"/>

NORTHPOINTE DRIVE

S37°16'08\"/>

S01°36'00\"/>

N89°45'12\"/>

S75°28'08\"/>

S16°53'34\"/>

N77°03'44\"/>

20.443 ACRES

N68°33'54\"/>

S21°17'59\"/>

S88°01'47\"/>

315.00'

S01°57'24\"/>

410.04'

S23°02'21\"/>

633.99'

EX. 20' UTILITY EASEMENT

EX. 20' UTILITY EASEMENT

EX. 20' UTILITY EASEMENT

EX. 20' UTILITY EASEMENT

EX. 20' UTILITY EASEMENT

EX. 20' UTILITY EASEMENT

EX. 20' UTILITY EASEMENT

EX. 20' UTILITY EASEMENT

EX. 20' UTILITY EASEMENT

EX. 20' UTILITY EASEMENT

EX. 20' UTILITY EASEMENT

EX. 20' UTILITY EASEMENT

EX. 20' UTILITY EASEMENT

EX. 20' UTILITY EASEMENT

EX. 20' UTILITY EASEMENT

EX. 20' UTILITY EASEMENT

EX. 20' UTILITY EASEMENT

EX. 20' UTILITY EASEMENT

EX. 20' UTILITY EASEMENT

EX. 20' UTILITY EASEMENT

EX. 20' UTILITY EASEMENT

EX. 20' UTILITY EASEMENT

EX. 20' UTILITY EASEMENT

EX. 20' UTILITY EASEMENT

EX. 20' UTILITY EASEMENT

EX. 20' UTILITY EASEMENT

EX. 20' UTILITY EASEMENT

EX. 20' UTILITY EASEMENT

EX. 20' UTILITY EASEMENT

EX. 20' UTILITY EASEMENT

EX. 20' UTILITY EASEMENT

EX. 20' UTILITY EASEMENT

EX. 20' UTILITY EASEMENT

EX. 20' UTILITY EASEMENT

EX. 20' UTILITY EASEMENT

EX. 20' UTILITY EASEMENT

EX. 20' UTILITY EASEMENT

EX. 20' UTILITY EASEMENT

EX. 20' UTILITY EASEMENT

EX. 20' UTILITY EASEMENT

EX. 20' UTILITY EASEMENT

EX. 20' UTILITY EASEMENT

EX. 20' UTILITY EASEMENT

EX. 20' UTILITY EASEMENT

EX. 20' UTILITY EASEMENT

EX. 20' UTILITY EASEMENT

EX. 20' UTILITY EASEMENT

EX. 20' UTILITY EASEMENT

EX. 20' UTILITY EASEMENT

EX. 20' UTILITY EASEMENT

EX. 20' UTILITY EASEMENT

EX. 20' UTILITY EASEMENT

EX. 20' UTILITY EASEMENT

EX. 20' UTILITY EASEMENT

EX. 20' UTILITY EASEMENT

EX. 20' UTILITY EASEMENT

EX. 20' UTILITY EASEMENT

EX. 20' UTILITY EASEMENT